





FEATURES

- Strain gauge based
- Aluminum construction
- Ideal for auditing the torque of aircraft control columns
- Ideal for propeller efficiency characterization

-  Non-loading surface, do not contact
-  Active End
-  Fixed End

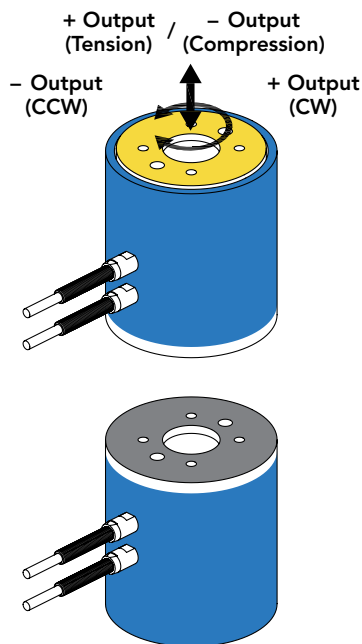

SPECIFICATIONS

PERFORMANCE

Nonlinearity	±0.25% of RO
Hysteresis	±0.25% of RO
Nonrepeatability	±0.05% of RO

ELECTRICAL

Rated Output (RO)	2 mV/V nom (50–150 lb) 3 mV/V nom (200 lb)
Excitation (VDC or VAC)	18 max
Bridge Resistance	350 Ohm
Insulation Resistance	≥500 MOhm @ 50 VDC
Connection	#28 AWG, 4 conductor, braided shielded PVC cable, 10 ft [3 m] long
Wiring Code	WC1

MECHANICAL

Weight (approximate)	6.5 oz (184 g)
Safe Overload	150% of RO (50–150 lb) 125% of RO (200 lb)
Material	Aluminum
IP Rating	IP40

TEMPERATURE

Operating Temperature	-45 to 200°F (-42 to 93°C)
Compensated Temperature	60 to 160°F (15 to 72°C)
Temperature Shift Zero	±0.005% of RO/°F (0.01% of RO/°C)
Temperature Shift Span	±0.005% of Load/°F (0.01% of Load/°C)

CALIBRATION

Calibration Test Excitation	10 VDC
Calibration (standard)	5-pt Compression, CW
Calibration (available)	5-pt Tension and Compression, CCW and CW
Shunt Calibration Value	60.4 kOhm (2 mV/V) 43.575 kOhm (3 mV/V)

DIMENSIONS inches [mm]

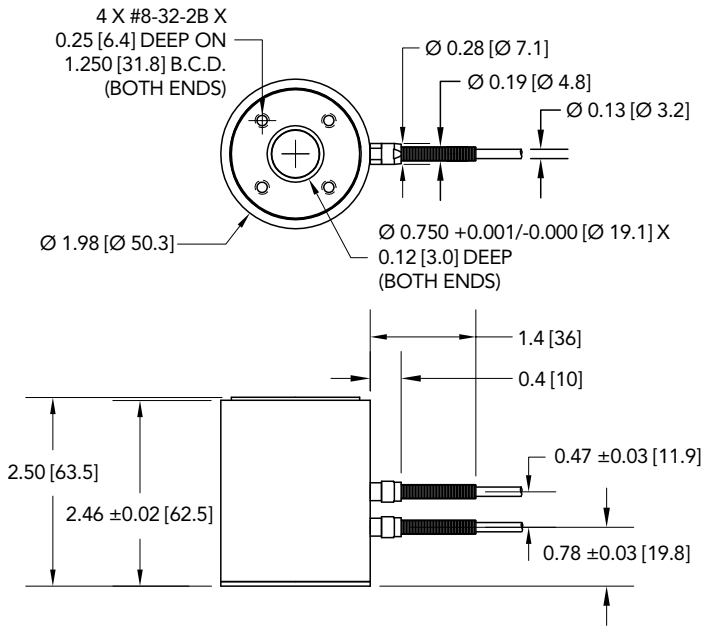

WIRING CODE (WC1 WITH SHIELD)

RED	+ EXCITATION
BLACK	- EXCITATION
GREEN	+ SIGNAL
WHITE	- SIGNAL
SHIELD	FLOATING

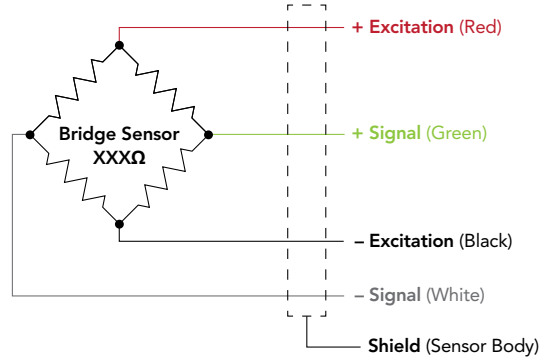

CAPACITIES

ITEM #	Load Capacity		Torque Capacity		Direction (in) (Fz only)	Natural Frequency (Hz) (Fz only)
	lb	N	in-lb	Nm		
FSH04259	50	222	50	5.65	0.001	2100
FSH04260	100	444	100	11.3	0.001	2700
FSH04261	200	890	200	23	0.002	2900



SCIGATE AUTOMATION (S) PTE LTD

No.1 Bukit Batok Street 22 #01-01 Singapore 659592
 Tel: (65) 6561 0488 Fax: (65) 6562 0588
 Email: sales@scigate.com.sg Web: www.scigate.com.sg
 Business Hours: Monday - Friday 8.30am - 6.15pm

Drawing Number: FI1451

FUTEK reserves the right to modify its design and specifications without notice.
 Please visit www.futek.com/salesterms for complete terms and conditions.

10 Thomas, Irvine, CA 92618 USA

Tel: (949) 465-0900
 Fax: (949) 465-0905

www.futek.com



U.S. Manufacturer