

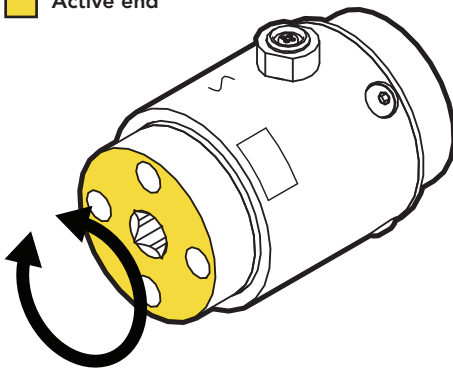

**FEATURES**

- Easily integrates into OEM applications
- Designed for Torque auditing
- Aluminum construction
- Built-in overload protection on lower ranges
- Strain gauge based

 Active end



- Output (CCW)  
+ Output (CW)

**SPECIFICATIONS**

**PERFORMANCE**

Nonlinearity	±0.2% of RO
Hysteresis	±0.2% of RO
Nonrepeatability	±0.05% of RO

**ELECTRICAL**

Rated Output (RO)	1 mV/V nom (5 in-oz) 2 mV/V nom (10 in-oz to 500 in-lb)
Excitation (VDC or VAC)	18 max
Bridge Resistance	350 Ohm nom (5 to 1000 in-oz) 700 Ohm nom (100 to 500 in-lb)
Connection	4 Pin LEMO® Receptacle (EGG. OB. 304 CLL)
Wiring Code	CC4

**MECHANICAL**

Weight (approximate)	14 oz [397 g]
Safe Overload	150% of RO
Material	Aluminum
IP Rating	IP40

**TEMPERATURE**

Operating Temperature	-60 to 200°F (-50 to 93°C)
Compensated Temperature	60 to 160°F (15 to 72°C)
Temperature Shift Zero	±0.002% of RO/°F (0.0036% of RO/°C)
Temperature Shift Span	±0.002% of Load/°F (0.0036% of Load/°C)

**CALIBRATION**

Calibration Test Excitation	10 VDC
Calibration (standard)	5-pt CW
Calibration (available)	5-pt CW & CCW
Shunt Calibration Value	60.4 kOhm (10 to 1000 in-oz) 100 kOhm (5 in-oz, 100 to 500 in-lb)

**DIMENSIONS inches [mm]**

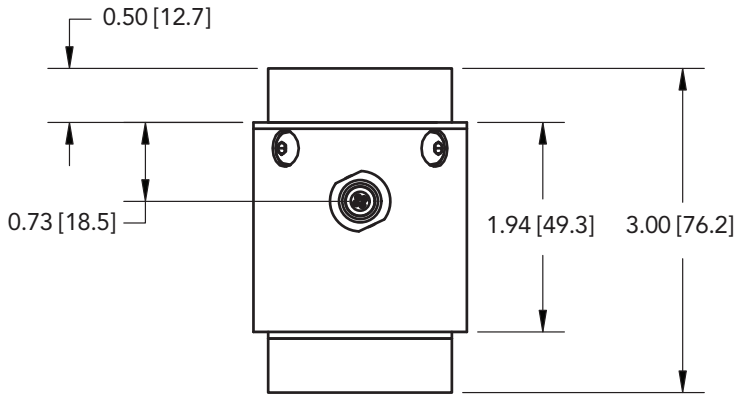

LEMO RECEPTACLE  
EGG.OB.304.CLL  
MATING CONNECTOR  
FGG.OB.304.CLAD35  
(NOT INCLUDED)

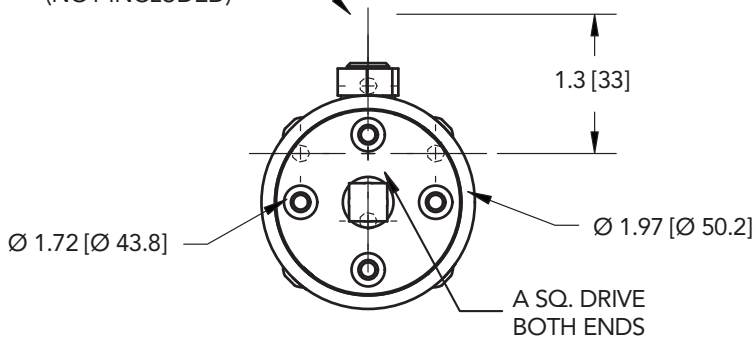

**CAPACITIES**

ITEM #	in-oz	Nm	A	Torsional Stiffness in-oz/rad
FSH02779	5*	0.04	1/4"	325
FSH02780	10*	0.07		650
FSH02782	50*	0.35		3500
FSH02784	160*	1.1		11000
FSH02785	400*	2.8		30000
FSH02786	1000	7.0		71000
FSH02787	100 in-lb	11	3/8"	77000 in-lb/rad
FSH02788	200 in-lb	22		95000 in-lb/rad
FSH02789	500 in-lb	56		199000 in-lb/rad

\* WITH OVERLOAD PROTECTION  
FOR HIGHER CAPACITIES REFER TO MODELS TFF600-750 AND TDF600-750  
AND TDF600-675

**CONNECTOR CODE (CC4)**

PIN	WIRING CODE
1	+ EXCITATION/RED
4	- EXCITATION/BLACK
2	+ SIGNAL/GREEN
3	- SIGNAL/WHITE

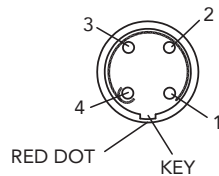



**SCIGATE AUTOMATION (S) PTE LTD**  
 No.1 Bukit Batok Street 22 #01-01 Singapore 659592  
 Tel: (65) 6561 0488 Fax: (65) 6562 0588  
 Email: sales@scigate.com.sg Web: www.scigate.com.sg  
 Business Hours: Monday - Friday 8.30am - 6.15pm

Drawing Number: FI1135-F

FUTEK reserves the right to modify its design and specifications without notice.  
 Please visit <http://www.futek.com/salesterms> for complete terms and conditions.

10 Thomas, Irvine, CA 92618 USA

Tel: (949) 465-0900  
 Fax: (949) 465-0905

[www.futek.com](http://www.futek.com)



U.S. Manufacturer