



## FEATURES

- Minimal mounting clearance
- 17-4 PH stainless-steel construction
- For use in both tension and compression
- Utilizes metal foil strain gauge technology
- Environmental Protection, IP67 Rated
- Fast Response time
- Water Resistant and Outdoor Rated

 Non-loading surface, do not contact

 Active End

 Fixed End

+ Output (tension)

- Output (compression)

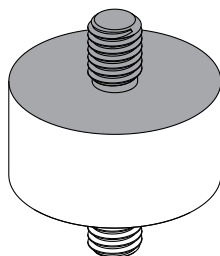
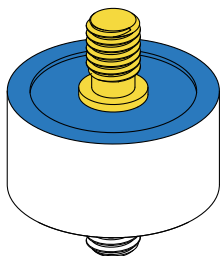

## SPECIFICATIONS

### PERFORMANCE

|                  |              |
|------------------|--------------|
| Nonlinearity     | ±0.25% of RO |
| Hysteresis       | ±0.25% of RO |
| Nonrepeatability | ±0.1% of RO  |

### ELECTRICAL

|                         |                             |
|-------------------------|-----------------------------|
| Rated Output (RO)       | 2 mV/V nom                  |
| Excitation (VDC or VAC) | 15 max                      |
| Bridge Resistance       | 740 Ohm nom                 |
| Insulation Resistance   | ≥500 MOhm @ 50 VDC          |
| Connection              | 4 Position Micro Receptacle |
| Wiring/Connector Code   | CC19                        |

### MECHANICAL

|                    |                         |
|--------------------|-------------------------|
| Weight             | 1.5 oz [42.5 g]         |
| Safe Overload      | 150% of RO              |
| Deflection         | See chart on next page  |
| Material (flexure) | 17-4 PH stainless-steel |
| IP Rating          | IP67                    |

### TEMPERATURE

|                         |                                       |
|-------------------------|---------------------------------------|
| Operating Temperature   | -60 to 200°F (-50 to 93°C)            |
| Compensated Temperature | 60 to 160°F (15 to 72°C)              |
| Temperature Shift Zero  | ±0.005% of RO/°F (±0.01 of RO/°C)     |
| Temperature Shift Span  | ±0.02% of load/°F (±0.036 of load/°C) |

### CALIBRATION

|                             |              |
|-----------------------------|--------------|
| Calibration Test Excitation | 10 VDC       |
| Calibration (standard)      | 5-pt Tension |
| Calibration (available)     | Compression  |
| Shunt Calibration Value     | 100 kOhm     |

### CONFORMITY

|      |                    |
|------|--------------------|
| RoHS | EU 2015/863        |
| CE   | EN55011; EN61326-1 |

## DIMENSIONS inches [mm]

TOLERANCE:  
 .X ± 0.1" [2.5 mm]  
 .XX ± 0.01" [0.25 mm]  
 .XXX ± 0.005" [0.127 mm]

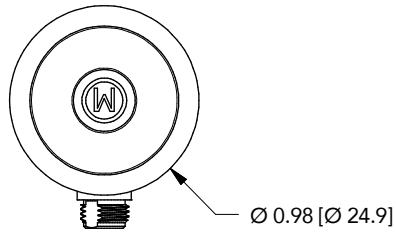

## FUTEK 4 PIN MICRO CIRCULAR (CC19)

|   |              |       |
|---|--------------|-------|
| 1 | + EXCITATION | Red   |
| 2 | - EXCITATION | Black |
| 3 | - SIGNAL     | White |
| 4 | + SIGNAL     | Green |

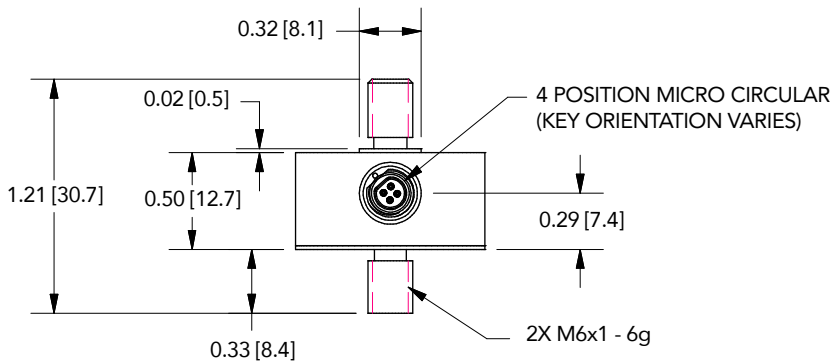

## CAPACITIES

| ITEM #   | lb   | N    | Deflection (in) | Natural Frequency (kHz) |
|----------|------|------|-----------------|-------------------------|
| FSH04530 | 50   | 223  | 0.002           | 6.1                     |
| FSH04531 | 100  | 445  | 0.001           | 10.9                    |
| FSH04532 | 250  | 1112 | 0.001           | 17                      |
| FSH04533 | 500  | 2224 | 0.001           | 23                      |
| FSH04534 | 1000 | 4448 | 0.001           | 29                      |



## SCIGATE AUTOMATION (S) PTE LTD

No.1 Bukit Batok Street 22 #01-01 Singapore 659592  
 Tel: (65) 6561 0488 Fax: (65) 6562 0588  
 Email: sales@scigate.com.sg Web: www.scigate.com.sg

Business Hours: Monday - Friday 8.30am - 6.15pm

Drawing Number: FI1534

FUTEK reserves the right to modify its design and specifications without notice.  
 Please visit <http://www.futek.com/salesterms> for complete terms and conditions.

10 Thomas, Irvine, CA 92618 USA  
 Tel: (949) 465-0900

[www.futek.com](http://www.futek.com)



RoHS



U.S. Manufacturer