



More Precision

wireSENSOR // Draw-wire displacement sensors





- Robust plastic housing
- Customised versions for OEM
- Potentiometer, current and voltage output

Model MK120 (Measuring range 3000, 5000mm)

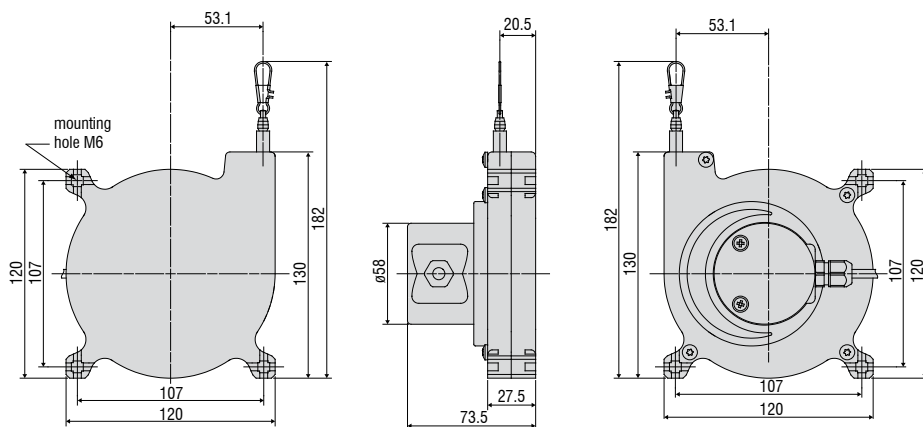

Model MK120 (Measuring range 7500mm)

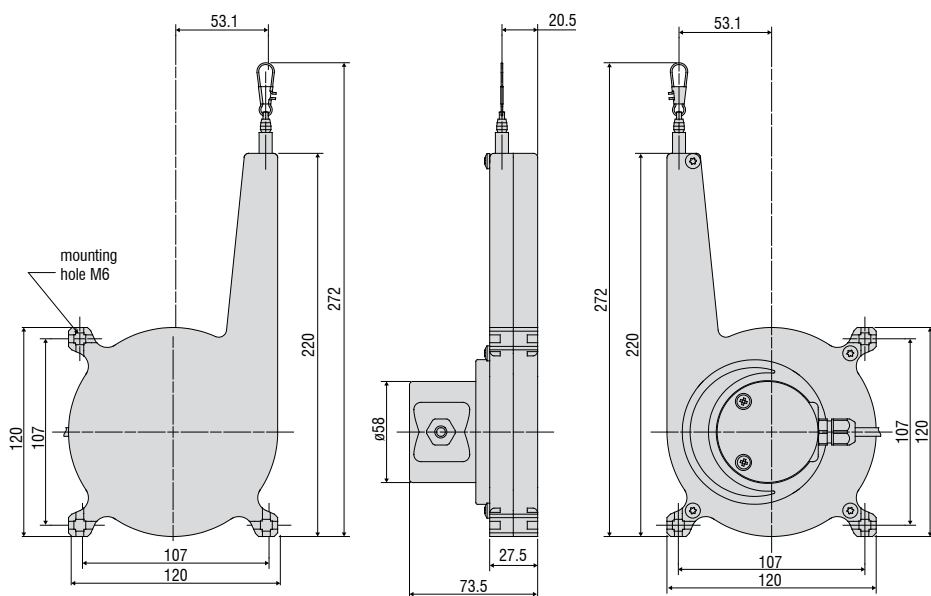

Model		WPS-3000-MK120	WPS-5000-MK120	WPS-7500-MK120
Output		P, U, I		
Measuring range		3000mm	5000mm	7500mm
Linearity	±0.15% FSO	± 4.5mm	± 7.5mm	± 11.25mm
Resolution		quasi infinite		
Temperature range		-20 to 80°C		
Material	housing	plastic PA6		
	draw wire	coated polamide stainless steel (ø 0.45mm)		
Wire mounting		wire clip		
Wire acceleration		2.5g		1.5g
Wire retraction force (min)		5.5N	5N	7N
Wire extension force (max)		8N		13N
Electrical connection		integrated cable, radial, 1m		
Protection class		IP 65		
Weight		0.75kg		0.9kg

FSO = Full Scale Output

Specifications for analogue outputs on page 47.

Article description

WPS -	3000 -	MK120 -	CR -	P
				Output option: P: potentiometer U: voltage I: current
				Connection CR: integrated cable, radial, 1m
				Model MK120
Measuring range in mm				

Accessories:

WE-xxx-M4	Wire extension with M4-wire connection, x=length
WE-xxx-Clip	Wire extension with eyelet, x=length
TR1-WDS	Pulley wheel, adjustable
TR3-WDS	Pulley wheel, fixed
GK1-WDS	Attachment head for M4
MH1-WDS	Magnetic holder for wire mounting
MH2-WDS	Magnetic holder for sensor mounting
MT-60-WDS	Mounting clamp for WDS-P60
FC8	Female connector for WDS, 8-pin
FC8/90	Female connector 90° for WDS
PC 3/8-WDS	Sensor cable, length 3m
PS 2020	(Power Supply 24 V / 2,5 A, Input 100 - 240 VAC, output 24 VDC / 2.5 A, for snap in mounting on DIN 50022 rail)
WDS-MP60	Mounting plate for P60 sensors

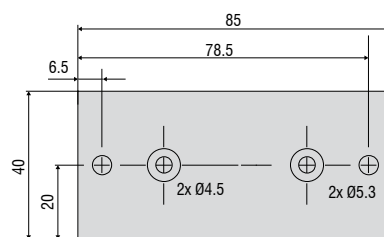
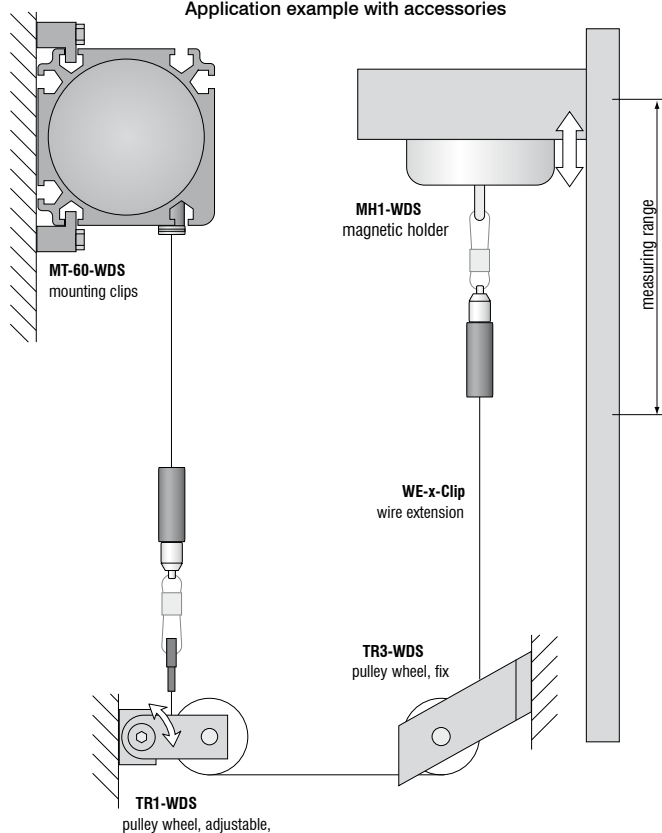
Application example with accessories

Mounting plate WDS-MP60

Installation information:

Wire attachment: The free return of the measurement wire is not permissible and it is essential that this is avoided during installation.

Wire exit angle:

When mounting a draw-wire displacement sensor, a straight wire exit ($\pm 3^\circ$ tolerance) must be taken into account. If this tolerance is exceeded, increased material wear on the wire and at the wire aperture must be expected.

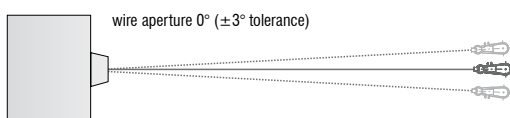

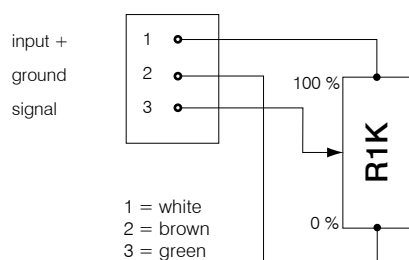
**Potentiometric output (P)**

Supply voltage	max. 32VDC at 1kOhm / 1 Wmax
Resistance	1kOhm $\pm 10\%$ (potentiometer)
Temperature coefficient	$\pm 0.0025\%$ FSO/ $^{\circ}\text{C}$
Sensitivity	depends on measuring range individually shown on test report

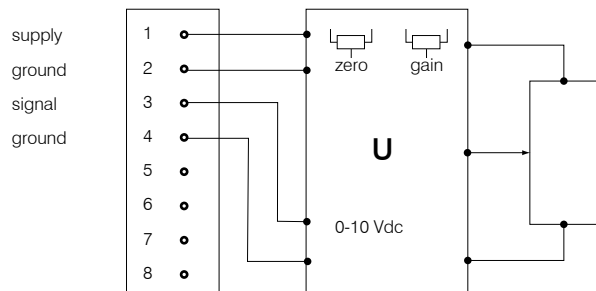
**Voltage output (U)**

Supply voltage	14 ... 27VDC (non stabilised)
Current consumption	max. 30mA
Output voltage	0 ... 10VDC Option 0 ... 5 / $\pm 5\text{V}$
Load impedance	$> 5\text{kOhm}$
Signal noise	$0.5\text{mV}_{\text{eff}}$
Temperature coefficient	$\pm 0.005\%$ FSO/ $^{\circ}\text{C}$
Electromagnetic compatibility (EMC)	EN 50081-2 EN 50082-2

Adjustment ranges

Zero	$\pm 20\%$ FSO
Sensitivity	$\pm 20\%$

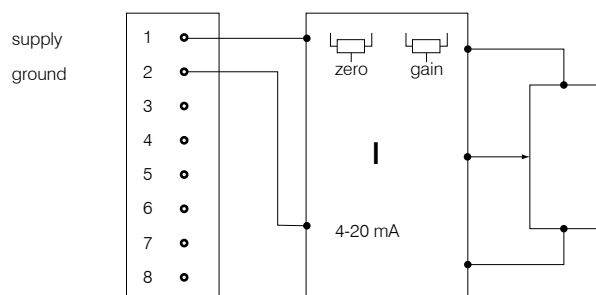
**Current Output (I)**

Supply voltage	14 ... 27VDC (non stabilised)
Current consumption	max. 35mA
Output current	4 ... 20mA
Load	$< 600\text{Ohm}$
Signal noise	$< 1.6\mu\text{A}_{\text{eff}}$
Temperature coefficient	$\pm 0.01\%$ FSO/ $^{\circ}\text{C}$
Electromagnetic compatibility (EMC)	EN 50081-2 EN 50082-2

Adjustment range

Zero	$\pm 18\%$ FSO
Sensitivity	$\pm 15\%$

High performance sensors made by Micro-Epsilon



Sensors and systems for displacement and position



Sensors and measurement devices for non-contact temperature measurement



2D/3D profile sensors (laser scanner)



Optical micrometers, fibre optic sensors and fibre optics



Colour recognition sensors, LED analysers and colour inline spectrometer



Measurement and inspection systems



SCIGATE AUTOMATION (S) PTE LTD

No.1 Bukit Batok Street 22 #01-01 Singapore 659592

Tel: +49 (0) 8542 / 168-0

Fax: (65) 6562 0588

Email: sales@scigate.com.sg

Web: www.scigate.com.sg

Business Hours: Monday - Friday 8.30am - 6.15pm



MICRO-EPSILON Headquarters
Koenigbacher Str. 15 · 94496 Ortenburg / Germany
Tel. +49 (0) 8542 / 168-0 · Fax +49 (0) 8542 / 168-90
info@micro-epsilon.com · www.micro-epsilon.com

MICRO-EPSILON UK Ltd.
No.1 Shorelines Building · Shore Road · Birkenhead · CH41 1AU
Phone +44 (0) 151 355 6070 · Fax +44 (0) 151 355 6075
info@micro-epsilon.co.uk · www.micro-epsilon.co.uk