

## IP65 Solution High Brightness Display

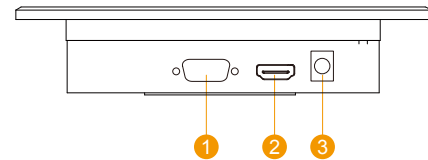

1. VGA
2. HDMI
3. DC input

I/O Optional	
Optional 1*	1 x VGA (D-sub 15) 1 x HDMI (Type-A) 1 x DVI-D
Optional 2*	1 x VGA (D-sub 15) 1 x DVI-D 1 x S-Video 1 x Composite

**SCIENCE GATE**  
Your Automation Partner



**SCIGATE AUTOMATION (S) PTE LTD**

No.1 Bukit Batok Street 22 #01-01 Singapore 659592

Tel: (65) 6561 0488

Fax: (65) 6562 0588

Email: sales@scigate.com.sg

Web: www.scigate.com.sg

Business Hours: Monday - Friday 8.30am - 6.15pm

5.7"

### Specifications

**RoHS**  
COMPLIANT  
2011/65/EU

Model Name	R05T100-IPD1HB
Panel Size	5.7"
Active Display Area(mm)	115.2 (H) x 86.4 (V)
Resolution	640 x 480
Brightness(cd/m2)	900 (Typical)
Contrast Ratio	300:1 (Typical)
Viewing Angles(CR>=10 L/R/U/D)	-70~70(H) ; -40~60(V)
Display Colors	262K (6 bits/color)
Standard Input Signal	1 x VGA (D-sub 15) 1 x HDMI (Type-A)
Touch Screen(Optional-1)	Resistive Touch Protective Glass
Touch Interface	USB / RS232
Audio / Speakers (Optional)*	Audio line in (3.5mm) + Speaker x2
OSD	5 Keys: -, +, Power, Esc, Enter
Power Input	12V DC input (2.5A) with external AC-DC Adapter (100V~240V)
Power Consumption	15W typical, Normal operation
Operating temperature	0~50°C
Storage Temperature	-10~60°C
Accessories	Power AC-DC Adapter(100V~240V) VGA cable (1.8m) HDMI cable (2m)

\*Outside dimension and I/O will be different from standard

### Mechanical Drawing

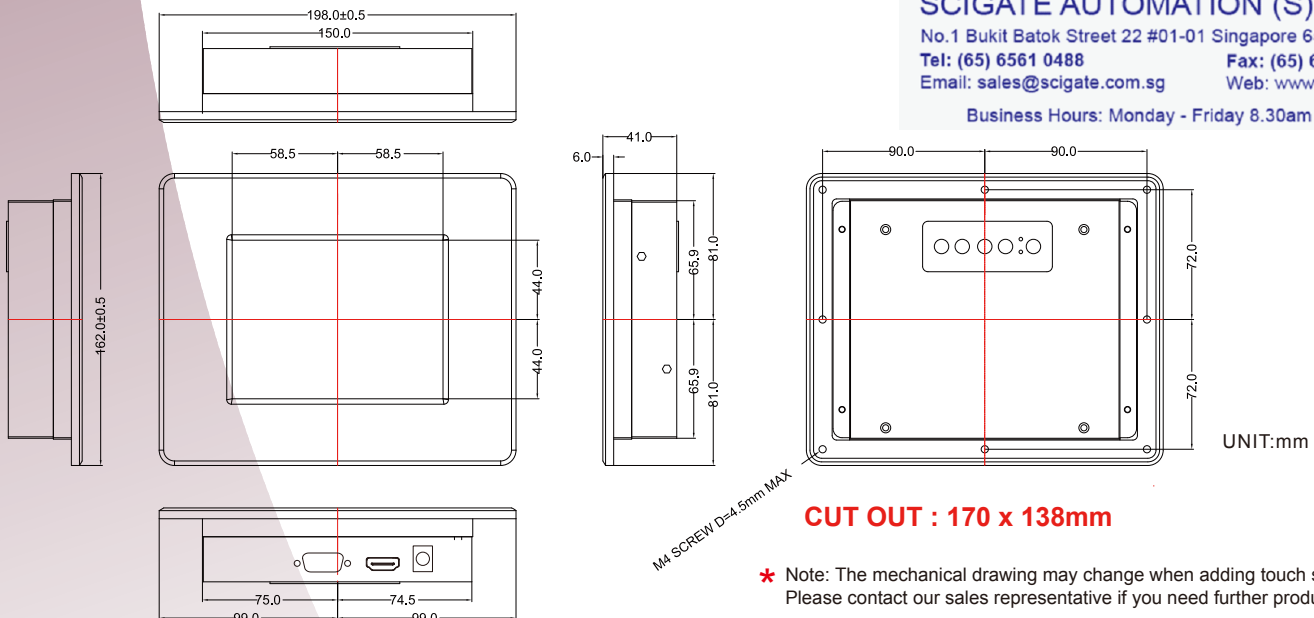

\* Note: The mechanical drawing may change when adding touch screen.  
Please contact our sales representative if you need further product information.