

# R08ID3S-IPT1WT 8.4" Panel PC (Intel® Atom™ Dual Core N2600 Processor)

## Mechanical Design

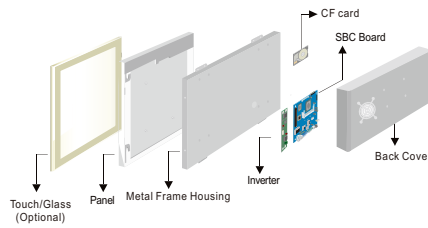

Ip65 (8mm front bezel)



Modularized Construction

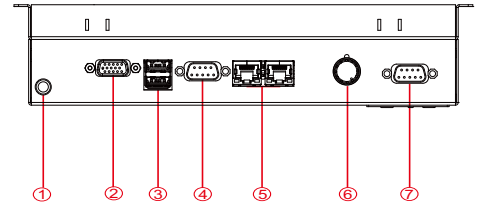

1. DC-IN Power Jack
2. VGA Out
3. USB
4. RS-232/422/485
5. RJ-45
6. Dimming Knob
7. RS-232

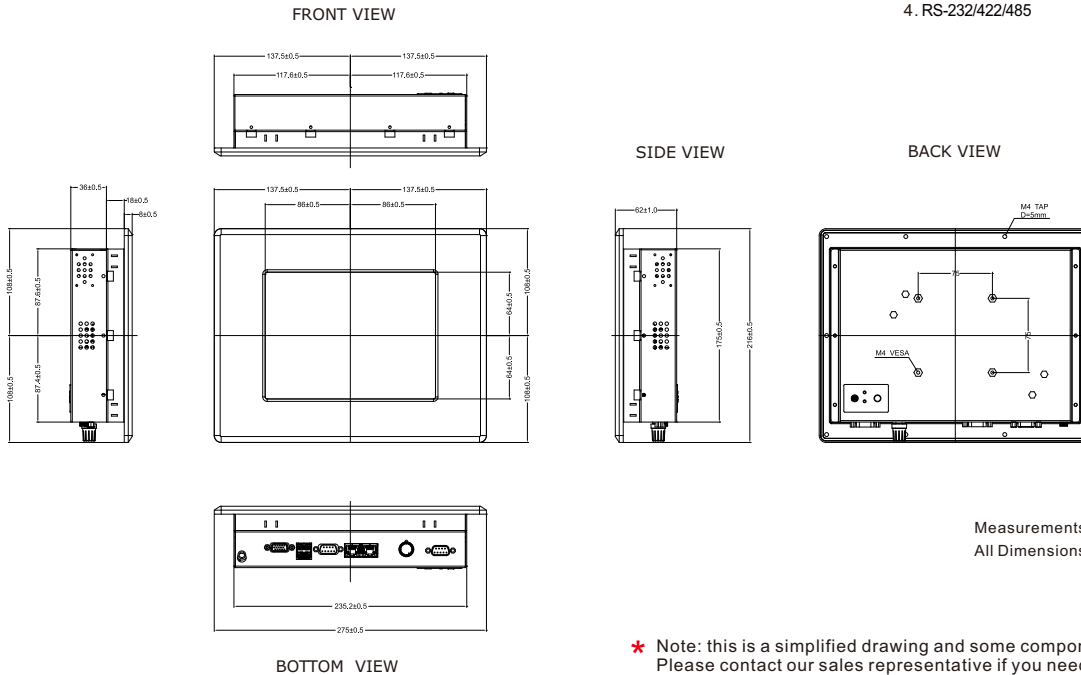

Measurements shown in mm  
All Dimensions are ± 0.5 mm

\* Note: this is a simplified drawing and some components are not marked in detail. Please contact our sales representative if you need further product information.

## Specifications

### System:

- CPU : Intel® Atom™ Dual Core N2600 1.6GHz Processor
- Memory Slot : 1 x SODIMM, Max 4GB DDR3 1333/1600
- System Chipset : Intel® NM10
- IDE/SATA : 2 x SATA
- LAN : Dual Broadcom BCM57780 GbE controller

### Accessories :

- External Power Supply 50W w/power cord

### Input / Output :

- Serial Ports : 1 x RS232, 1 x RS232/422/485
  - USB Ports : 2 x USB
  - Ethernet : 2 x RJ45-10/100/1000
  - VGA : 1 x VGA
  - Power Input : 1 x DC-IN Power Jack
- Default setting: RS232

### Panel Spec :

- Size/Type : 8.4" TFT
- Resolutions : 800x600
- Brightness : 450cd/m (typ.)
- Contrast Ratio : 600: 1 (typ.)
- Viewing Angle : -80~80(H); -60~80(V)
- Max Colors : 16.2M (8bits/color)

### Environment Considerations :

- Operating Temperature : -20 deg.C to 60 deg.C
- Operating Humidity : 30% to 90% (non condensing)

### Expansion Slots:

- 1 x Mini PCIe slot (for wireless module)
  - 1 x Mini PCIe slot (for SATA SSD)
- \* A customized housing is needed if you would like to have the PCI expansion.

### Power Specifications :

- Power Input : 12V DC-IN Power input
- Power Consumption : 35W (typ.)(Max.backlight & high CPU load)

### Order Options :

Mechanical : Open Frame Panel Mount (8mm bezel) IP65 (8mm bezel) Chassis	RAM : SODIMM DDR3 1333/1600
Touch : 4 Wires Resistive(Optional)	OS : Windows 7 embedded / Windows XP embedded (Optional)



SCIGATE AUTOMATION (S) PTE LTD  
No.1 Bukit Batok Street 22 #01-01 Singapore 659592  
Tel: (65) 6561 0488 Fax: (65) 6562 0588  
Email: sales@scigate.com.sg Web: www.scigate.com.sg  
Business Hours: Monday - Friday 8.30am - 6.15pm



Note: All Specifications are subject to change without prior notice!

date: 02-Feb-2017 V1.8