

# R15IC7T-IPC3 15" Panel PC (Intel® Core™ i7-620M/i5-520M)

Mechanical Design

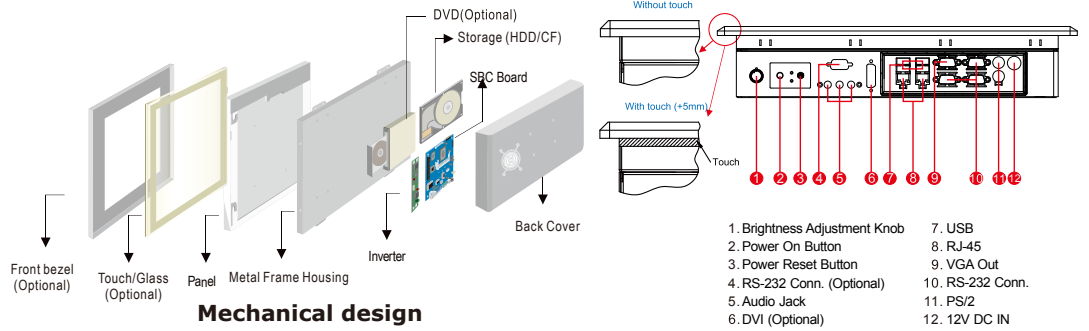

IP65 (10 mm front bezel)



Mechanical design

## Dimensions

## Fully Integrated I/O

FRONT VIEW

SIDE VIEW

BACK VIEW

IP65 CUT OUT

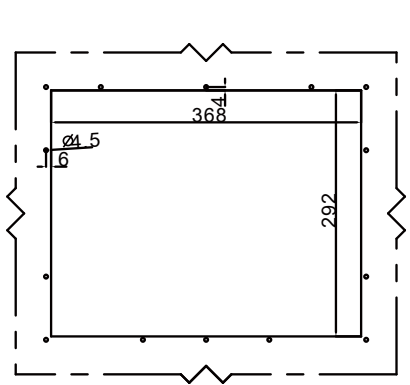
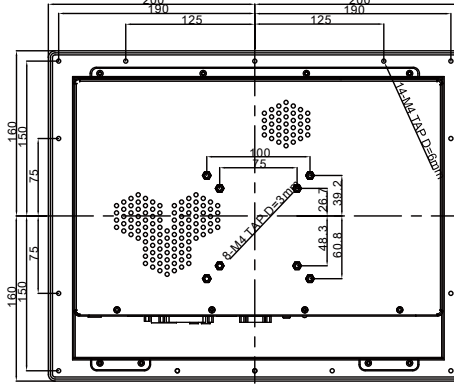
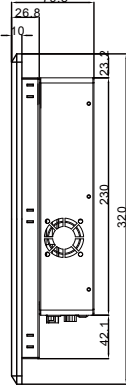
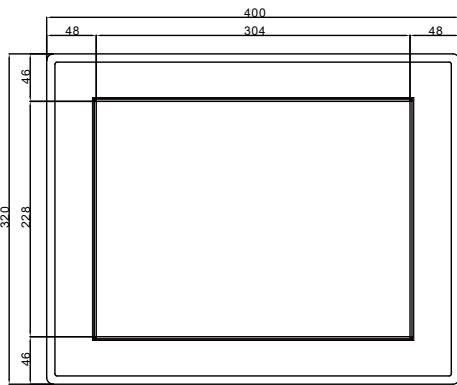

1:2

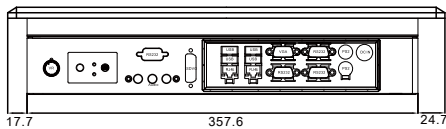

BOTTOM VIEW

- \* Measurements shown in mm
- \* Tolerance of all dimensions is shown as follow 0~30 mm ± 0.1 mm, 30~50 mm ± 0.15 mm, 50~120 mm ± 0.2 mm, above 120 mm ± 0.25 mm
- \* Note: this is a simplified drawing and some components are not marked in detail. Please contact our sales representative if you need further product information.

## Specifications

### System :

- CPU : Intel® Core™ i7-620M/i5-520M Processor (2.66GHz / 2.4GHz)
- Memory : 2 x SO-DIMM, Max 8GB DDR3 1333/1600
- System Chipset : Intel® HM55 Chipset
- Storage : 2 x SATA II
- LAN : Dual Broadcom BCM57780 GbE
- Audio Codec : Realtek ALC886 HD Audio Codec

### Input / Output :

- Serial Ports : 2 x RS232, 1 x RS232/422/485
- USB Ports : 4 x USB
- Keyboard / Mouse : 2 x PS/2
- Ethernet : 2 x RJ 45-10/100/1000 Mbps
- VGA : 1 x VGA (female)
- Audio : Line-Out, Line-In, Mic in

• Default setting:RS232

### Expansion Slot :

- 1 x PCI-E(x16), 2 x Mini PCI-E

### Power Specifications :

- Power Input : 12V DC IN
- Power Consumption : 107W (typ.)(Max.backlight & high CPU load)

### Accessories :

- Mounting Kit (for Panel Mount 5 mm)
- External Power Supply 150W/power cord

### Panel Spec :

- Size/Type : 15" TFT
- Resolutions : 1024 x 768
- Brightness : 250 cd/m<sup>2</sup> (typ.)
- Contrast Ratio : 500 : 1(typ.)
- Viewing Angles : -70~70(H);-60~60(V)
- Max Colors : 16.2M

### Environment Considerations :

- Operating Temperature : 0 deg.C to 50 deg.C
- Operating Humidity : 30% to 90% (non condensing)

### OS BSP / Driver Support :

- Support Windows 7 / Windows XP Embedded / Windows XPP Embedded / Linux

### Order Options :

- |  |  |
|--|--|
| Mechanical : Open Frame<br>Panel Mount(5 mm bezel)<br>IP65(10 mm bezel)    | Storage : <b>3.5" HDD/CF/Both</b>  |
| Touch : 5 Wires Resistive(Optional)  | RAM : SO-DIMM DDR3   |
|  | OS : Windows XPE (Optional)<br>Windows XPPE (Optional)<br>Windows 7 (Optional)<br>Linux (Optional) |
| (A customized housing is needed if you have demands of SAW/IR/IT/SC touch) | DVD : Yes(Optional)  |

**SCIENCE GATE**  
Your Automation Partner

SCIGATE AUTOMATION (S) PTE LTD  
No.1 Bukit Batok Street 22 #01-01 Singapore 659592  
Tel: (65) 6561 0488 Fax: (65) 6562 0588  
Email: sales@scigate.com.sg Web: www.scigate.com.sg  
Business Hours: Monday - Friday 8.30am - 6.15pm



Note: All Specifications are subject to change without prior notice!

Revised Date: 11-May-2017 V1.2