

# R15ID7T-IPA3WT 15" Panel PC (Intel® Atom Dual Core N2800+NM10 Platform)

## Mechanical Design

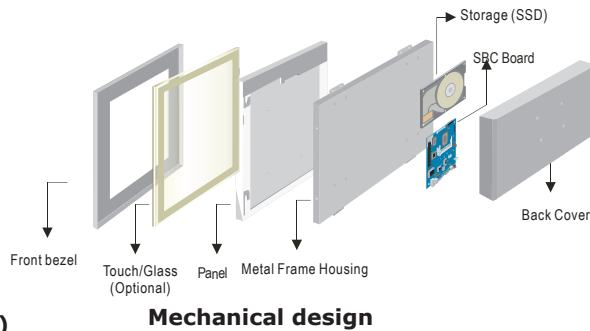

Panel Mount (10 mm front bezel)



Mechanical design

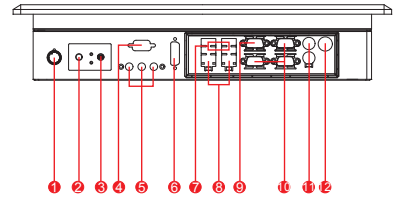

- |                               |                      |
|-------------------------------|----------------------|
| 1. Brightness Adjustment Knob | 7. USB               |
| 2. Power On Button            | 8. LAN               |
| 3. Power Reset Button         | 9. VGA Out           |
| 4. RS-232 Conn.(Optional)     | 10. RS-232 Conn.     |
| 5. Audio Jack                 | 11. PS/2             |
| 6. DVI (Optional)             | 12. DC-IN Power Jack |

## Fully Integrated I/O

### IP65 CUT OUT

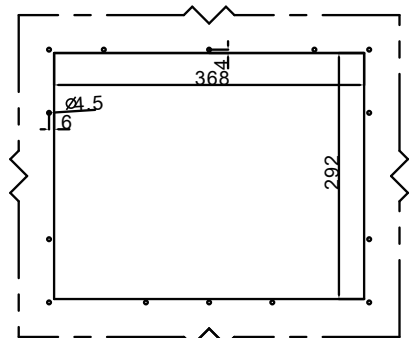

1:2

### FRONT VIEW

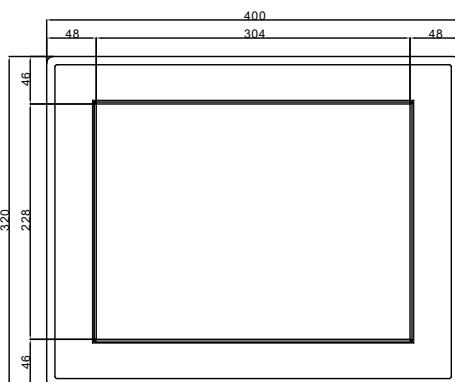

### SIDE VIEW

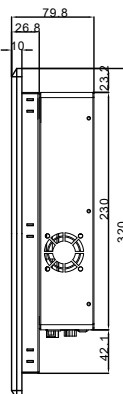

### Dimensions

### BACK VIEW

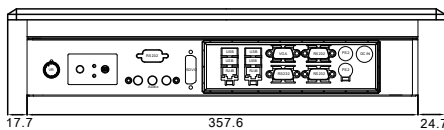
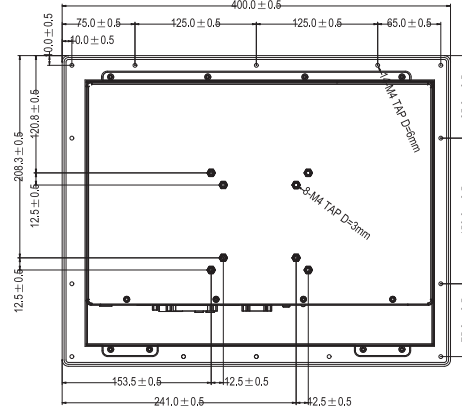

BOTTOM VIEW

- \* Measurements shown in mm
- \* Tolerance of all dimensions is shown as follow 0~30 mm ± 0.1mm, 30~50 mm ± 0.15 mm, 50~120 mm ± 0.2 mm, above 120 mm ± 0.25 mm
- \* Note: this is a simplified drawing and some components are not marked in detail. Please contact our sales representative if you need further product information.

## Specifications

### System :

- CPU : Intel® Atom Dual-core N2800 1.86GHz
- Memory Slot : 1 x SODIMM, Max 4GB DDR3 800/1066
- System Chipset : Intel® NM10
- IDE/SATA : 2 x SATA
- LAN : Dual Broadcom BCM57780 GbE controller
- Audio Codec : Realtek ALC886 HD Audio Codec
- Storage : mSATA SSD 32GB (Default)

### Input / Output :

- Serial Ports : 2 x RS232, 1 x RS232/422/485
  - USB Ports : 4 x USB Type-A Receptacle
  - Keyboard / Mouse : 2 x PS/2
  - Ethernet : 2 x RJ 45-10/100/1000 Mbps
  - VGA : 1 x VGA (female)
  - Audio : Line-Out, Line-In, Mic in
- Default setting:RS232

### Expansion Slot :

- 1 x Mini PCIe slot (for wireless module)
- 1 x Mini PCIe slot (for 3G module)

### Environment Considerations :

- Operating Temperature : -20 deg.C to 60deg.C
- Operating Humidity : 30% to 90% (non condensing)

### Panel Spec :

- Size/Type : 15" TFT
- Resolutions : 1024x768
- Brightness : 400cd/m (typ.)
- Contrast Ratio : 700 : 1 (typ.)
- Viewing Angle : -80~80(H);-80~60(V)
- Max. Colors : 16.2M / 262K colors

### Power Specifications :

- Power Input : 12V DC-IN Power input
- Power Consumption : 38W (typ.)(Max.backlight & high CPU load)

### Accessories :

- External Power Supply 80W Adapter w/power cord

### Order Options :

- Touch : 5 Wires Resistive (Optional)
- RAM : SODIMM DDR3 1066
- OS : Windows 7 embedded / Windows XP embedded (Optional)



### SCIGATE AUTOMATION (S) PTE LTD

No.1 Bukit Batok Street 22 #01-01 Singapore 659592  
 Tel: (65) 6561 0488 Fax: (65) 6562 0588  
 Email: sales@scigate.com.sg Web: www.scigate.com.sg  
 Business Hours: Monday - Friday 8.30am - 6.15pm

