

R15ID7T-IPC3HB 15" Panel PC (Intel® Atom Dual Core D2550+NM10 Platform)

Mechanical Design

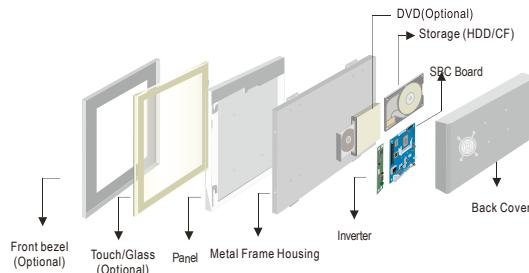

IP65 (10mm front bezel)



Modularized Construction

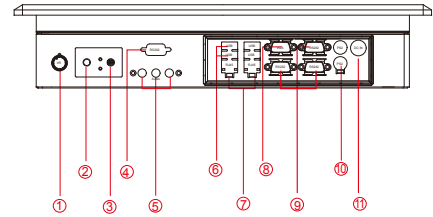

- | | |
|--------------------------------|----------------------|
| 1. Brightness Adjustment Knodo | 7. RJ-45 |
| 2. Power On Button | 8. VGA Out |
| 3. Power Reset Button | 9. RS-232 Conn. |
| 4. RS-232 Conn.(Optional) | 10. PS/2 |
| 5. Audio Jack | 11. DC-IN Power Jack |
| 6. USB | |

Fully Integrated I/O

IP65 CUT OUT

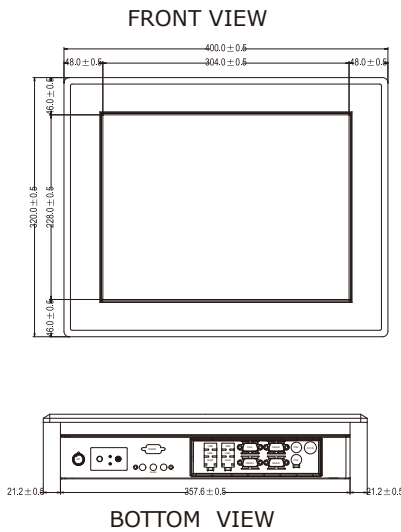

Measurements shown in mm All Dimensions are ±

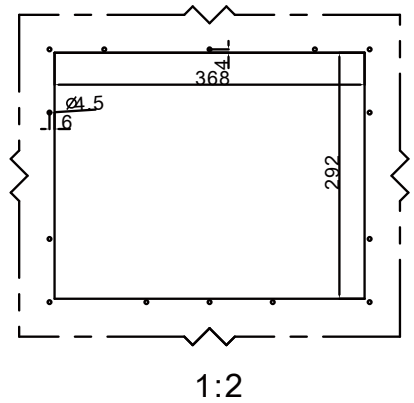

* Note: this is a simplified drawing and some components are not marked in detail. Please contact our sales representative if you need further product information.

Specifications

System :

- CPU : Intel® Atom Dual Core D2550 1.86GHz Processor
- Memory Slot : DDR3 1066 MHz SO-DIMM Slot, Max. 4GB
- System Chipset : NM10
- IDE/SATA : 2 x SATA
- LAN : Dual Broadcom BCM57780 GbE controller
- Audio Codec : Realtek ALC886 HD Audio Codec

Panel Spec :

- Size/Type : 15" TFT
- Resolutions : 1024 x 768
- Brightness : 800 cd/m² (typ.)
- Contrast Ratio : 700 : 1 (typ.)
- Viewing Angles : -80~80(H); -70~70(V)
- Max Colors : 16.2M (8 bit) / 262K (6 bit)

Input / Output :

- Serial Ports : 2 x RS232, 1 x RS232/422/485
- USB Ports : 4 x USB Type-A Receptacle
- Keyboard / Mouse : 2 x PS/2
- Ethernet : 2 x RJ 45-10/100/1000 Mbps
- VGA : 1 x VGA (female)
- Audio : Line-Out, Line-In, Mic in

• Default setting:RS232

Environment Considerations :

- Operating Temperature : 0°C to 45°C
- Operating Humidity : 30% to 90% (non condensing)

OS BSP / Driver Support :

- Support Windows 7

Power Specifications :

- Power Input : 12V DC IN (Lockable Power Jack)
- Power Consumption : 38W (typ.)

Accessories :

- External Adapter : 110~230V Ac-in power adapter

Order Options :

- | | |
|--|---------------------------------|
| Mechanical : Open Frame
Panel Mount(10 mm bezel)
IP65(10 mm bezel) | Storage : 2.5" HDD/ 2.5"SSD/ CF |
| Touch : 5 Wires Resistive(Optional) | RAM : DDR3 1066 Max 4GB |
| | OS : Windows 7(Optional) |

(A customized housing is needed if you have demands of SAW/IR/SC touch)



SCIGATE AUTOMATION (S) PTE LTD

No.1 Bukit Batok Street 22 #01-01 Singapore 659592
 Tel: (65) 6561 0488 Fax: (65) 6562 0588
 Email: sales@scigate.com.sg Web: www.scigate.com.sg

Business Hours: Monday - Friday 8.30am - 6.15pm



Note: All Specifications are subject to change without prior notice!

date: 12-May-2017 V1.4