

R15IH7T-IPC3

15" Panel PC (Intel® 4th Generation Core™ i5 Platform)

Mechanical Design



IP65 (10mm front bezel)

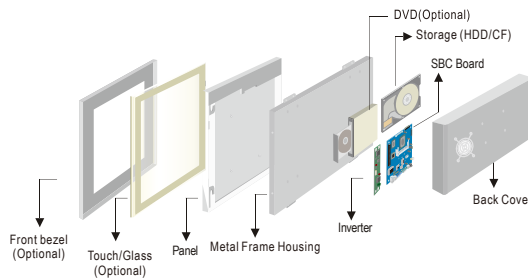

Modularized Construction

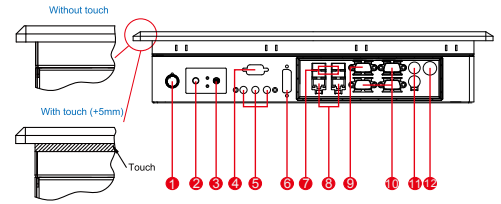

1. Brightness Adjustment Knob
2. Power On Button
3. Power Reset Button
4. RS-232 Conn. (Optional)
5. Audio Jack
6. DVI (Optional)
7. USB
8. RJ-45
9. VGA Out
10. RS-232 Conn.
11. PS/2
12. 12V DC IN

Fully Integrated I/O

Dimensions

FRONT VIEW

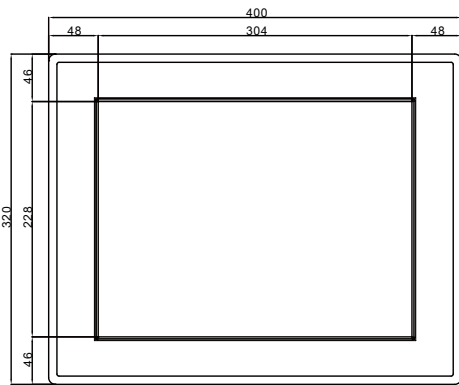

SIDE VIEW

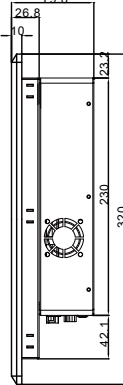

BACK VIEW

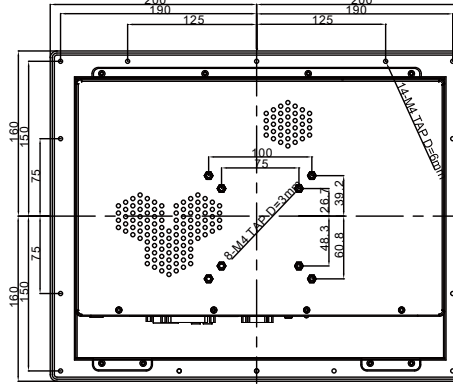

IP65 CUT OUT

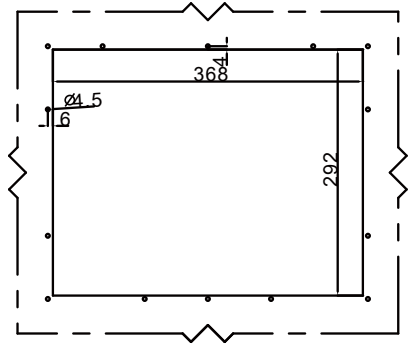

1:2

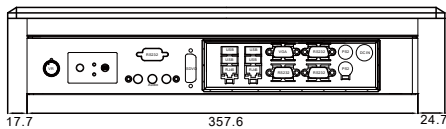

BOTTOM VIEW

- * Measurements shown in mm
- * Tolerance of all dimensions is shown as follow 0~30 mm ± 0.1 mm, 30~50 mm ± 0.15 mm, 50~120 mm ± 0.2 mm, above 120 mm ± 0.25 mm
- * Note: this is a simplified drawing and some components are not marked in detail. Please contact our sales representative if you need further product information.

Specifications

System

- CPU : Intel® 4th Generation Core™ i5-4200M 2.5GHz (Max. 3.1GHz) Processor
- Memory Slot : 2 x SO-DIMM, Max 16GB DDR3L 1333/1600
- System Chipset : Intel® QM87 Chipset
- IDE/SATA : 2XSATA III
- LAN : Intel® Ethernet Controller I211-AT + Intel® Gigabit Ethernet PHY I218-LM
- Audio Codec : Realtek ALC886 HD Audio Codec

Input / Output

- Serial Ports : 2 x RS232, 1 x RS232/422/485
- USB Ports : 4 x USB 3.0
- Keyboard / Mouse : 2 x PS/2
- Ethernet : 2 x RJ45-10/100/1000Mbps
- VGA : 1 x VGA (female)

• Default setting:RS232

Power Specifications

- Power Input : 12V DC IN
- Power Consumption : 58W (typ.)(Max.backlight & high CPU load)

Accessories

- External Adapter : 110~240V Ac-in Power Adapter



SCIGATE AUTOMATION (S) PTE LTD
 No.1 Bukit Batok Street 22 #01-01 Singapore 659592
 Tel: (65) 6561 0488 Fax: (65) 6562 0588
 Email: sales@scigate.com.sg Web: www.scigate.com.sg

Business Hours: Monday - Friday 8.30am - 6.15pm

Note: All Specifications are subject to change without prior notice!

Panel Spec

- Size/Type : 15" TFT LCD
- Resolutions : 1024 x 768
- Brightness : 250 cd/m² (typ.)
- Contrast Ratio : 500 : 1 (typ.)
- Viewing Angles : -70~70(H); -60~60(V)
- Max Colors : 16.2M

Environment Considerations

- Operating Temperature : 0 deg.C to 50 deg.C
- Operating Humidity : 30% to 90% (non condensing)

OS BSP / Driver Support

- Support Windows 7 / Windows 8 embedded / Windows 10 IoT Enterprise

Order Options

- | | |
|-------------------------------------|---|
| Mechanical : IP65(10mm bezel) | Storage: 2.5" HDD/mSATA |
| Touch : 5 Wires Resistive(Optional) | RAM : DDR3L 1333/1600 MAX 16GB |
| | OS : Windows 7 / Windows 8 embedded / Windows 10 IoT Enterprise |

(A customized housing is needed if you have demands of SAW/IR/IT/SC touch)



Revised Date:27-Jun-2016 V1.1