

R15IV7T-IPC3 15" Panel PC (Intel® 3rd Generation Core™ i7/i5/i3)

Mechanical Design

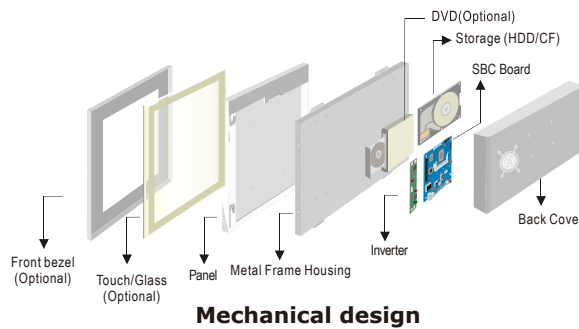

IP65 (10 mm front bezel)



Mechanical design

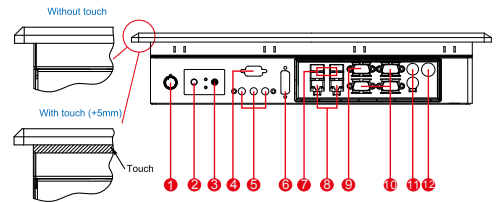

1. Brightness Adjustment Knob
2. Power On Button
3. Power Reset Button
4. RS-232 Conn. (Optional)
5. Audio Jack
6. DVI (Optional)
7. USB
8. RJ-45
9. VGA Out
10. RS-232 Conn.
11. PS/2
12. 12V DC IN

Dimensions

Fully Integrated I/O

FRONT VIEW

SIDE VIEW

BACK VIEW

IP65 CUT OUT

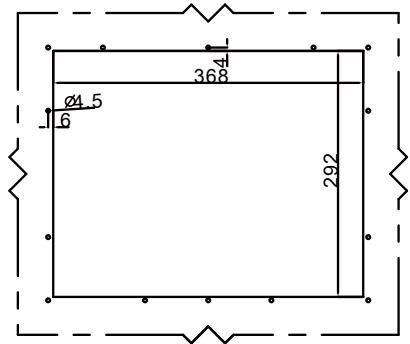
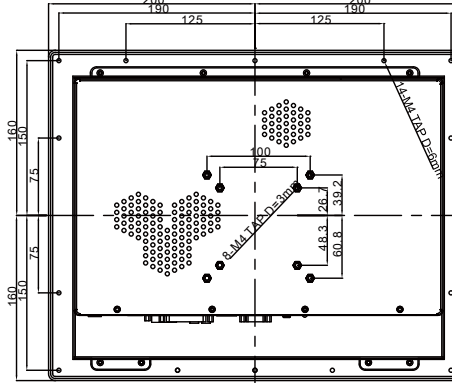
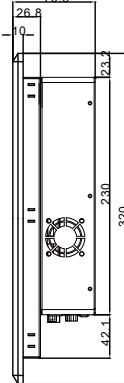
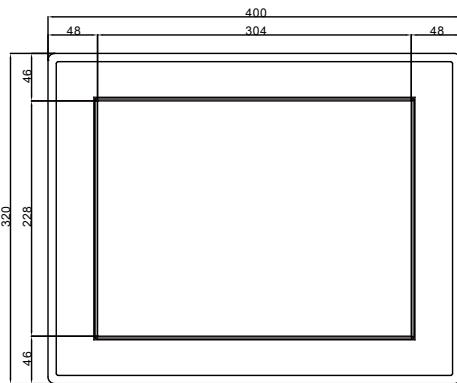

1:2

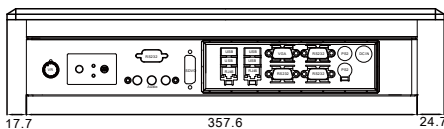

BOTTOM VIEW

- * Measurements shown in mm
- * Tolerance of all dimensions is shown as follow 0~30 mm ± 0.1 mm, 30~50 mm ± 0.15 mm, 50~120 mm ± 0.2 mm, above 120 mm ± 0.25 mm
- * Note: this is a simplified drawing and some components are not marked in detail. Please contact our sales representative if you need further product information.

Specifications

System:

- CPU : Intel® 3rd Generation Core™ i7/i5/i3
- Memory : 2 x SO-DIMM, Max 16GB DDR3L 1333-1600
- System Chipset : Intel® HM76 Chipset
- Storage : 1 x SATAIII, 1 x SATAII, 1 x mSATA
- LAN : Dual Broadcom BCM57780 GbE
- Audio Codec : Realtek ALC886 HD Audio Codec

Panel Spec:

- Size/Type : 15" TFT
- Resolutions : 1024 x 768
- Brightness : 250 cd/m² (typ.)
- Contrast Ratio : 500 : 1 (typ.)
- Viewing Angles : -70~70(H); -60~60(V)
- Max Colors : 16.2M

Input / Output:

- Serial Ports : 2 x RS232, 1 x RS232/422/485
- USB Ports : 4 x USB 3.0
- Keyboard / Mouse : 2 x PS/2
- Ethernet : 2 x RJ 45-10/100/1000 Mbps
- VGA : 1 x VGA (female)
- Audio : Line-Out, Line-In, Mic in

• Default setting: RS232

Environment Considerations:

- Operating Temperature : 0 deg.C to 50 deg.C
- Operating Humidity : 30% to 90% (non condensing)

OS BSP / Driver Support:

- Support Windows 10 IoT Enterprise / WindowsXP Embedded / Windows7 Embedded / Windows8 Embedded

Expansion Slot:

- 1 x PCI-E(x16), 2 x Mini PCI-E

Power Specifications:

- Power Input : 12V DC IN
- Power Consumption : 87W (typ.)(Max.backlight & high CPU load)

Accessories:

- Mounting Kit (for Panel Mount 5 mm)
- External Power Supply 110~240V AC- in power adapter

Order Options:

Mechanical : Open Frame IP65(10 mm bezel)	Storage : 2.5" HDD / mSATA SSD
Touch : 5 Wires Resistive(Optional)	RAM : SO-DIMM DDR3L 1600
	OS : Windows 10 IoT Enterprise Windows XP Embedded Windows 7 Embedded Windows 8 Embedded
(A customized housing is needed if you have demands of SAW/IR/IT/SC touch)	DVD : Yes(Optional)

SCIENCE GATE
Your Automation Partner

SCIGATE AUTOMATION (S) PTE LTD
No.1 Bukit Batok Street 22 #01-01 Singapore 659592
Tel: (65) 6561 0488 Fax: (65) 6562 0588
Email: sales@scigate.com.sg Web: www.scigate.com.sg
Business Hours: Monday - Friday 8.30am - 6.15pm



Note: All Specifications are subject to change without prior notice!

Revised date: 06/17/2016 V1.2