

R15IV7T-PMC3 15" Panel PC (Intel® 3rd Generation Core™ i7/i5)

Mechanical Design

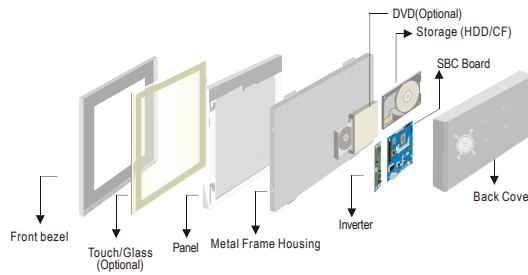

Panel Mount (10mm front bezel)



Mechanical design

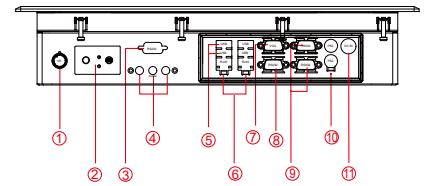

1. Brightness Adjustment Knob
2. OSD Membrane
3. RS-232 Conn. (Optional)
4. Audio Jack
5. USB
6. RJ-45
7. VGA Out
8. RS-232/422/485
9. RS-232 Conn.
10. PS/2
11. 12V DC-IN

Dimensions

Fully Integrated I/O

FRONT VIEW

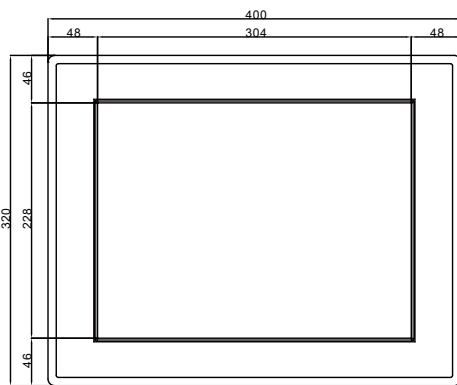

SIDE VIEW

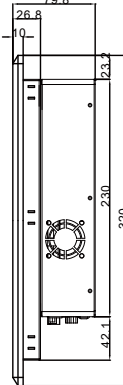

BACK VIEW

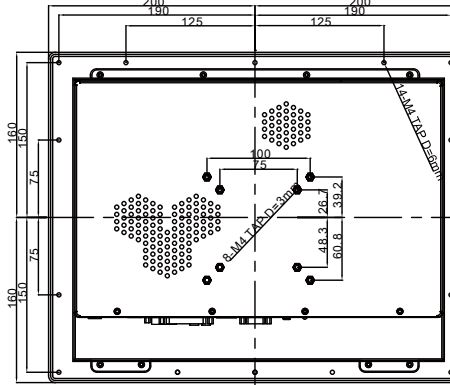

IP65 CUT OUT

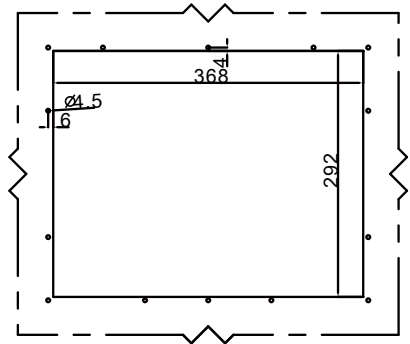

1:2

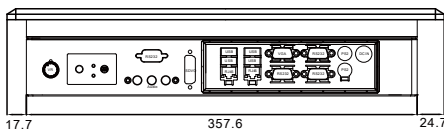

BOTTOM VIEW

- * Measurements shown in mm
- * Tolerance of all dimensions is shown as follow 0~30 mm ± 0.1 mm, 30~50 mm ± 0.15 mm, 50~120 mm ± 0.2 mm, above 120 mm ± 0.25 mm
- * Note: this is a simplified drawing and some components are not marked in detail. Please contact our sales representative if you need further product information.

Specifications

System Specifications :

- CPU : Intel® 3rd Generation Core™ i7-3520M 2.9GHz, turo to 3.6GHz
Intel® 3rd Generation Core™ i5-3230M 2.6GHz, turo to 3.2GHz
- System Chipset : Intel HM76 Chipset
- System Memory : 2 x DDR3L 1333/1600MHz SO-DIMM, max. 16GB
- Audio : Realtek ALC886 HD Audio Codec
- Network : Dual Broadcom BCM57780 PCIe GbE LAN Controller
- IDE/SATA : 1 x SATA III, 1 x SATA II

Input / Output :

- Serial Ports : 2 x RS232, 1 x RS232/422/485
- USB Ports : 4 x USB 3.0
- Keyboard / Mouse : 2 x PS/2
- Ethernet : 2 x RJ 45-10/100/1000 Mbps
- VGA : 1 x VGA (female)
- Audio : Line-Out, Line-In, Mic in

Expansion Slot :

- 2 x Mini PCIe (1 for WiFi, 1 for WWAN Module), 1xPCIe x16, 1xPCIe x 4
* A customized housing is needed if you would like to have the PCIe expansion.

Power Management :

- Power Input : 12V DC IN (Lockable Power Jack)
- Power Consumption : 87W (typ.) (Max. backlight & high CPU load)

Accessories :

- External Adapter : 110~240V Ac-in Power Adapter

Display Specifications :

- Size/Type : 15" TFT
- Resolution : 1024 x 768
- Contrast Ratio : 2000:1
- Brightness : 300 nits (Optional 400 nits)
- Viewing Angle : -88~88 (H) ; -88~88 (V)
- Max Colors : 16.2M

Environment :

- Operating Temperature : 0°C to 50°C
- Operating Humidity : 30% to 90% (non condensing)

OS BSP / Driver Support :

- Support Windows 7 Embedded / Windows 8 Embedded / Windows 10 IoT Enterprise

Order Options :

- | | |
|---|---|
| Mechanical : Panel Mount (10 mm bezel) | Storage : 2.5" HDD/ 2.5" SSD/ mSATA SSD |
| Touch : 5 Wire Resistive (Optional) AR Glass (Optional) | RAM : DDR3L 1333/1600MHz SO-DIMM, max. 16GB |
| | OS : Windows 7 Embedded/ Windows 8 Embedded / Windows 10 IoT Enterprise |
- (A customized housing is needed if you have demands of SAW/IR/SC touch)



SCIGATE AUTOMATION (S) PTE LTD

Bukit Batok Street 22 #01-01 Singapore 659592
Tel: (65) 6561 0488 Fax: (65) 6561 0588
Email: sales@scigate.com.sg Web: https://scigate.com.sg/

Business Hours: Monday - Friday 8:30AM - 6:15PM



Revised Date: 09-Oct-2018 V1.5

Note: All Specifications are subject to change without prior notice!