

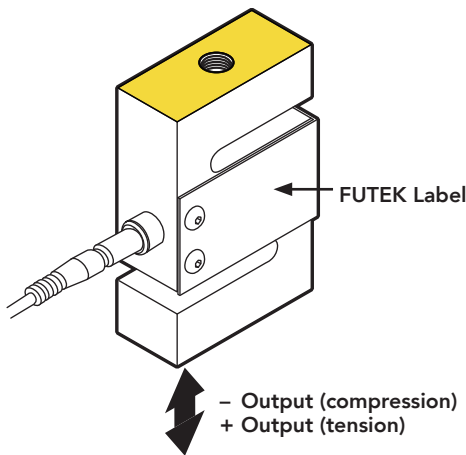

**FEATURES**

- For in line use in both tension and compression
- Notable nonlinearity
- Connector or robust cable strain relief

**Mounting end**



**SPECIFICATIONS**

**PERFORMANCE**

Nonlinearity	±0.1% of RO
Hysteresis	±0.05% of RO
Nonrepeatability	±0.05% of RO

**ELECTRICAL**

Rated Output (RO)	2 mV/V nom
Excitation (VDC or VAC)	20 max
Bridge Resistance	1000 Ohm nom
Connection	LEMO® connector receptacle standard. #28 AWG, 6 conductor, polyurethane cable, 5 ft [1.5 m] long optional
Wiring/Connector Code	CC4 standard, WC4 optional

**MECHANICAL**

Weight (approximate)	7.5 oz [212 g] (2000 lb - 18 oz [510 g])
Safe Overload	150% of RO
Material	Anodized Aluminum (2000 lb - 17-4 PH stainless-steel)
IP Rating	IP64

**TEMPERATURE**

Operating Temperature	-60 to 200°F [-50 to 93°C] -40 to 180°F [-40 to 82°C] (Cable Version)
Compensated Temperature	60 to 160°F [15 to 72°C]
Temperature Shift Zero	±0.001% of RO/°F [0.0018% of RO/°C]
Temperature Shift Span	±0.0008% of Load/°F [0.0014% of Load/°C]

**CALIBRATION**

Calibration Test Excitation	10 VDC
Calibration (standard)	5-pt Tension; 150 kOhm Shunt Cal. Value
Calibration (available)	Compression



**SCIGATE AUTOMATION (S) PTE LTD**

No.1 Bukit Batok Street 22 #01-01 Singapore 659592  
**Tel: (65) 6561 0488** **Fax: (65) 6562 0588**  
 Email: [sales@scigate.com.sg](mailto:sales@scigate.com.sg) Web: [www.scigate.com.sg](http://www.scigate.com.sg)

Business Hours: Monday - Friday 8.30am - 6.15pm



**DIMENSIONS** inches [mm]

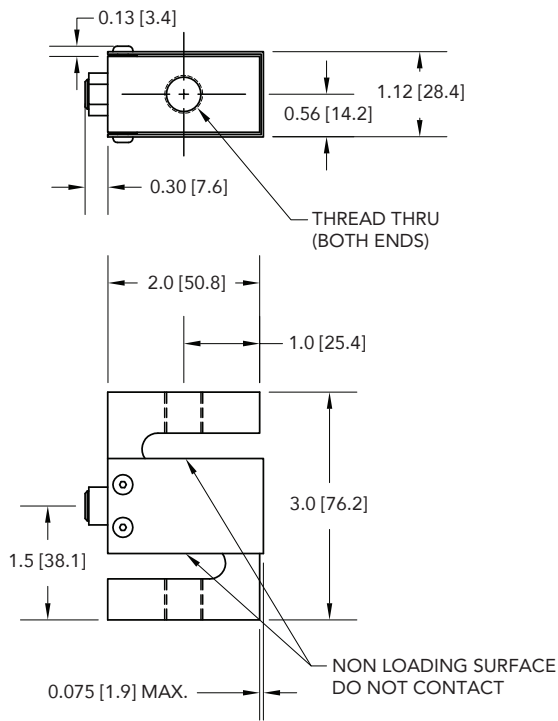

#28 AWG, 6 Conductor PU Cable (5ft) Option

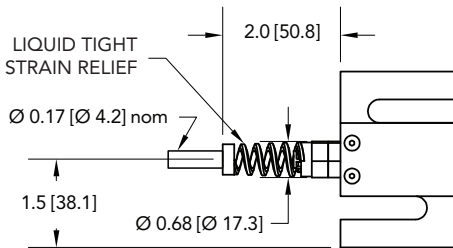

**WIRING CODE (WC4)**

RED	+ EXCITATION
BLACK	- EXCITATION
GREEN	+ SIGNAL
WHITE	- SIGNAL
ORANGE	+ SENSE
BLUE	- SENSE
SHIELD	GROUND

**CAPACITIES**

ITEM #	lb	N	Thread	Natural Frequency (Hz)	Deflection (in.)	Connector	
						LEMO®	Cable
FSH00967	500	2224	1/2-20	1400	0.010	X	
FSH02072						X	
FSH00966			M12 x 1.75			X	
FSH01591							X
FSH00971	1000	4448	1/2-20	1500	0.015	X	
FSH02070						X	
FSH00970			M12 x 1.75			X	
FSH01592							X
FSH00973	2000	8896	1/2-20	1300	0.016	X	
FSH02068						X	
FSH00972			M12 x 1.75			X	
FSH01593							X

**LEMO 4-PIN**

PIN	COLOR	DESCRIPTION
1	Red	+ Excitation
2	Green	+ Signal
3	White	- Signal
4	Black	- Excitation

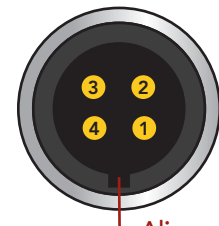

Align with key

Sensor Receptacle View

Drawing Number: F11073-C

FUTEK reserves the right to modify its design and specifications without notice. Please visit [www.futek.com/salesterms](http://www.futek.com/salesterms) for complete terms and conditions.

10 Thomas, Irvine, CA 92618 USA

Tel: (949) 465-0900  
Fax: (949) 465-0905

[www.futek.com](http://www.futek.com)



U.S. Manufacturer