

FUTEK MODEL LCM100 SUBMINIATURE, THREADED, TENSION & COMPRESSION LOAD CELL, IP67 RATED

ITEM NUMBER: QSH01870

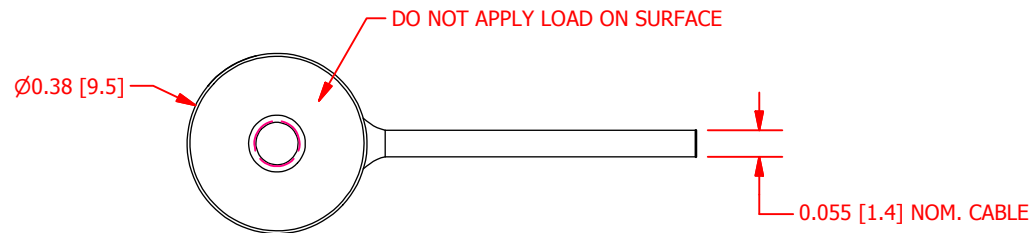

| | | | |
|--------------|--------------|--------------------|----------|
| INCH [mm] | | R.O.= Rated Output | |
| WIRING CODE | | | |
| + Excitation | - Excitation | + Signal | - Signal |
| RED | BLACK | GREEN | WHITE |
| Shield | | | |
| FLOATING | | | |

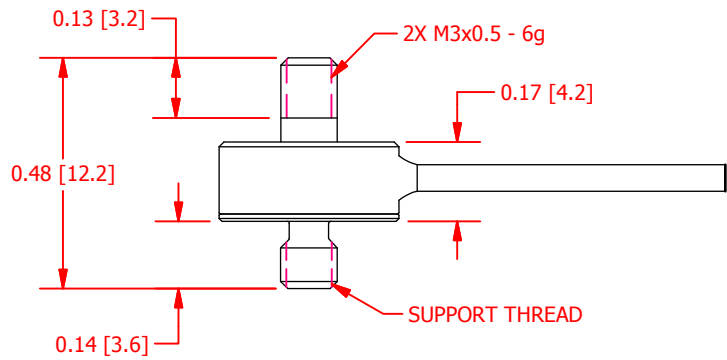
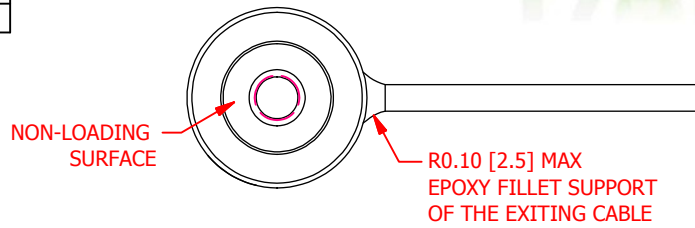
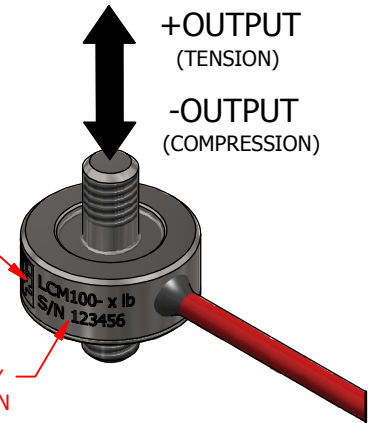

SPECIFICATIONS:

| | |
|---|---------------------------------------|
| CAPACITY | 1000 g |
| RATED OUTPUT | 1 mV/V nom. |
| SAFE OVERLOAD | 150% of R.O. |
| ZERO BALANCE | ±6% of R.O. |
| EXCITATION (VDC OR VAC) | 7 V MAX |
| BRIDGE RESISTANCE | 350 Ω nom. |
| NONLINEARITY | ±0.5% of R.O. |
| HYSTERESIS | ±0.5% of R.O. |
| NONREPEATABILITY | ±0.1% of R.O. |
| TEMP. SHIFT ZERO | ±0.01% of R.O./°F (±0.018 of R.O./°C) |
| TEMP. SHIFT SPAN | ±0.01% of LOAD/°F (±0.018 of LOAD/°C) |
| COMPENSATED TEMP. | 60 to 160 °F (16 to 71 °C) |
| OPERATING TEMP | -60 to 200 °F (-51 to 93 °C) |
| WEIGHT (approx) | 0.3 oz [8.5 g] |
| MATERIAL | 17-4 PH.S.S. |
| IP RATING | IP 67 |
| CABLE: #34 Avg 4 Conductor Braided Shielded, Red Polyester Cable, 5 ft [1.5 m] Long | |
| RoHS | 2011/65/EU |



SCIGATE AUTOMATION (S) PTE LTD
 No.1 Bukit Batok Street 22 #01-01 Singapore 659592
 Tel: (65) 6561 0488 Fax: (65) 6562 0588
 Email: sales@scigate.com.sg Web: www.scigate.com.sg
 Business Hours: Monday - Friday 8.30am - 6.15pm

| |
|--|
| CUSTOMER APPROVAL- COMPANY: |
| CUSTOMER APPROVAL- NAME / DATE: |
| REVISIONS: (Refer to dwg # revision sheet) |
| |
| |

OUTLINE DRAWING

STANDARD NOTES: (Unless Otherwise Specified)
 ALL DIMENSIONS ARE IN INCHES
 DRAWING INTERPRETATION DIMS. PER ASME-Y14.5M
 REMOVE BURRS AND BREAK SHARP EDGES .005 - .015
 THREADS PER HANDBOOK H-28
 DIMENSIONS ARE SHOWN AFTER PLATING

ANGLE: ± 1/2°
 CHAMFER: ± 5°
 TOLERANCE:
 .X ± 0.1"
 .XX ± 0.01"
 .XXX ± 0.005"

3rd ANGLE PROJ.

This drawing is submitted solely for the information and exclusive use of the original addressee. It is not to be divulged in whole or in part, by any firm or individual without written permission from:

FUTEK
 ADVANCED SENSOR TECHNOLOGY, INC.
 10 THOMAS, IRVINE, CA 92618 USA
 Phone: (949) 465-0900
 Fax: (949) 465-0905

| | |
|------------------------|---------------------------|
| MODEL: LCM100 | DWG No.: FO1430 |
| DRAWN BY: M. Lisiak | CREATED DATE: 8/29/2016 |
| APPROVED BY: R. Walker | APPROVED DATE: 8/29/2016 |
| CHECKED BY: | CAGE: 1X8M6 SHEET: 1 OF 1 |