

# FUTEK MODEL LSM300

## SPECIAL PARALLELOGRAM LOAD CELL W/OVERLOAD PROTECTION AND PRECISION ALIGNMENT FEATURE

ITEM NUMBER: QSH02044

INCH [mm] | R.O.= Rated Output

### WIRING CODE\*

+ Excitation	- Excitation	+Signal	-Signal
GREEN	BLACK	WHITE	RED

\*COLOR CODE FOR THIS SENSOR IS NOT FUTEK STANDARD

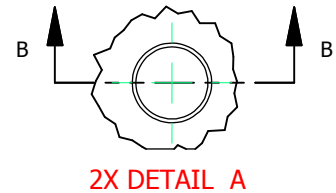
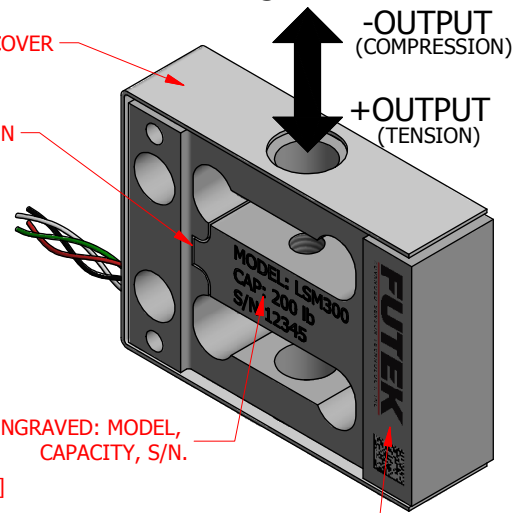
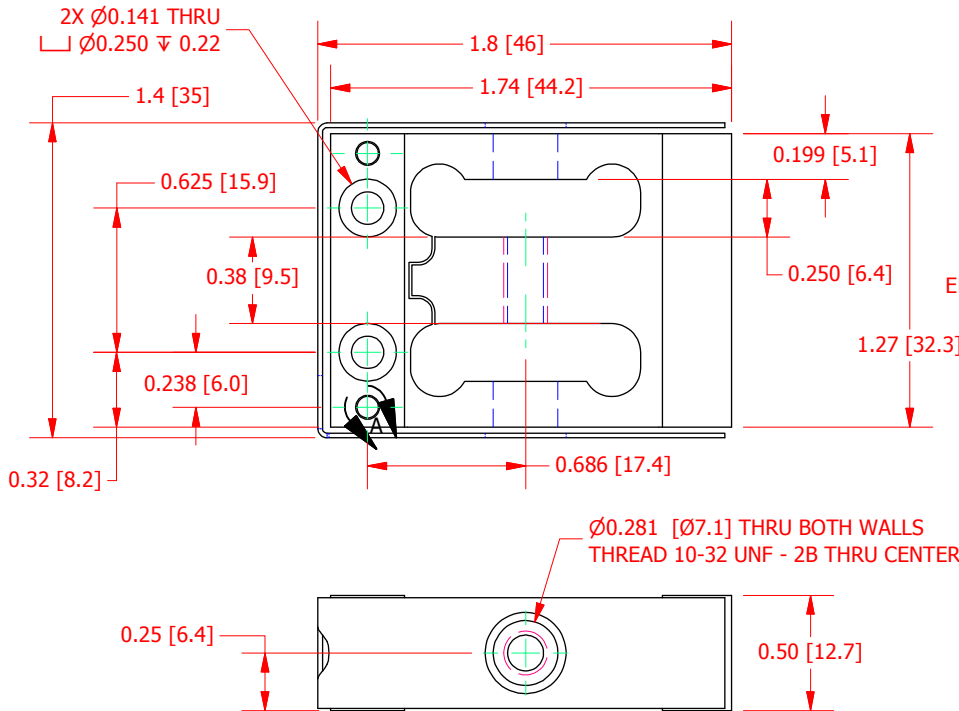

### SPECIFICATIONS:

RATED OUTPUT	2 mV/V nom.
CAPACITY	200 lb. [888N]
SAFE OVERLOAD	200 % of R.O.
ZERO BALANCE	±3% of R.O.
EXCITATION (VDC OR VAC)	18 MAX
BRIDGE RESISTANCE	1000 Ω nom.
NONLINEARITY	±0.06% of R.O.
HYSTERESIS	±0.06% of R.O.
NONREPEATABILITY	±0.02% of R.O.
CREEP	±0.025% of R.O.
TEMP. SHIFT ZERO	±0.005% of R.O./°F (±0.009 of R.O./°C)
TEMP. SHIFT SPAN	±0.005% of LOAD/°F (±0.009 of LOAD/°C)
COMPENSATED TEMP.	60 to 160 °F (16 to 71 °C)
OPERATING TEMP	-60 to 200 °F (-51 to 93 °C)
WEIGHT (approx)	0.2 lb [90.7 g]
MATERIAL	17-4 PH S.S.
CABLE: #29 Awg 4 Conductor, Spiral Teflon Cable, 6in [152mm] Long	
CALIBRATION TEST EXCITATION	10 VDC
CALIBRATION (STD)	2 pt. TENSION, 150 kOhm SHUNT CAL. VALUE



SCIGATE AUTOMATION (S) PTE LTD

No. 1 Bukit Batok Street 22 #01-01 Singapore 659592  
Tel: (65) 6561 0488 Fax: (65) 6562 0588  
Email: sales@scigate.com.sg Web: www.scigate.com.sg  
Business Hours: Monday - Friday 8.30am - 6.15pm



Ø0.1035 ± 0.0025 [2.63 ± 0.06] ▽ 0.25 [6.3]

⊕ Ø0.005 (M) A

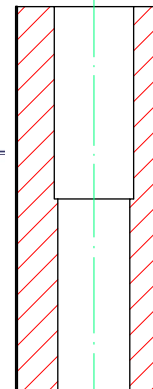

Ø0.094 ± 0.001 [2.38 ± 0.03] THRU A

SECTION B-B

CUSTOMER APPROVAL- COMPANY:

CUSTOMER APPROVAL- NAME / DATE:

REVISIONS: (Refer to dwg # revision sheet)

## OUTLINE DRAWING

STANDARD NOTES: (Unless Otherwise Specified)

ALL DIMENSIONS ARE IN INCHES  
DRAWING INTERPRETATION DIMS. PER ASME-Y14.5  
REMOVE BURRS AND BREAK SHARP EDGES .005 - .015  
THREADS PER HANDBOOK H-28  
DIMENSIONS ARE SHOWN AFTER PLATING

ANGLE:  
± 1/2°

CHAMFER:  
± 5°

TOLERANCE:  
.X ± 0.1"  
.XX ± 0.01"  
.XXX ± 0.005"

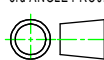

This drawing is submitted solely for the information and exclusive use of the original addressee. It is not to be divulged in whole or in part, by any firm or individual without written permission from:

**FUTEK**  
ADVANCED SENSOR TECHNOLOGY, INC.

10 THOMAS, IRVINE, CA 92618 USA  
Phone: (949) 465-0900  
Fax: (949) 465-0905

MODEL: <b>LSM300</b>	DWG No.: <b>FO1487</b>
DRAWN BY: M. Lisiak	CREATED DATE: 10/11/2018
APPROVED BY: R. Walker	APPROVED DATE: 10/12/2018
CHECKED BY:	CAGE: 1X8M6 SHEET: 1 OF 1