

# Pro-face

by **Schneider** Electric

Touch Operator Interface

# GP4100 SERIES

Color model

4.3" Wide  
480 x 272 pixel  
TFT 65k Colors

Small, but **Powerful** and Easy-to-Use



## Easy Data Handling

Easily handle on-site data with USB Type A and Ethernet interfaces.

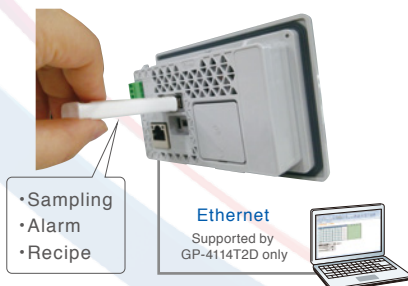

**Pro-ServerEX**

## Easy Customization

Multi-language support screen-creation software.



**GP-ProEX**

## Easy Replacement

The Panel Cutout Adaptor allows for easy replacement of monochrome model.

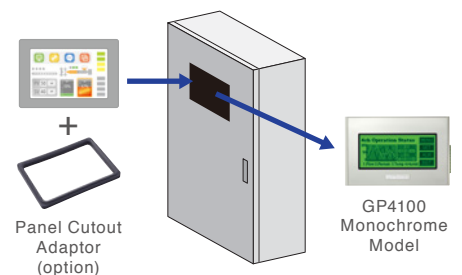

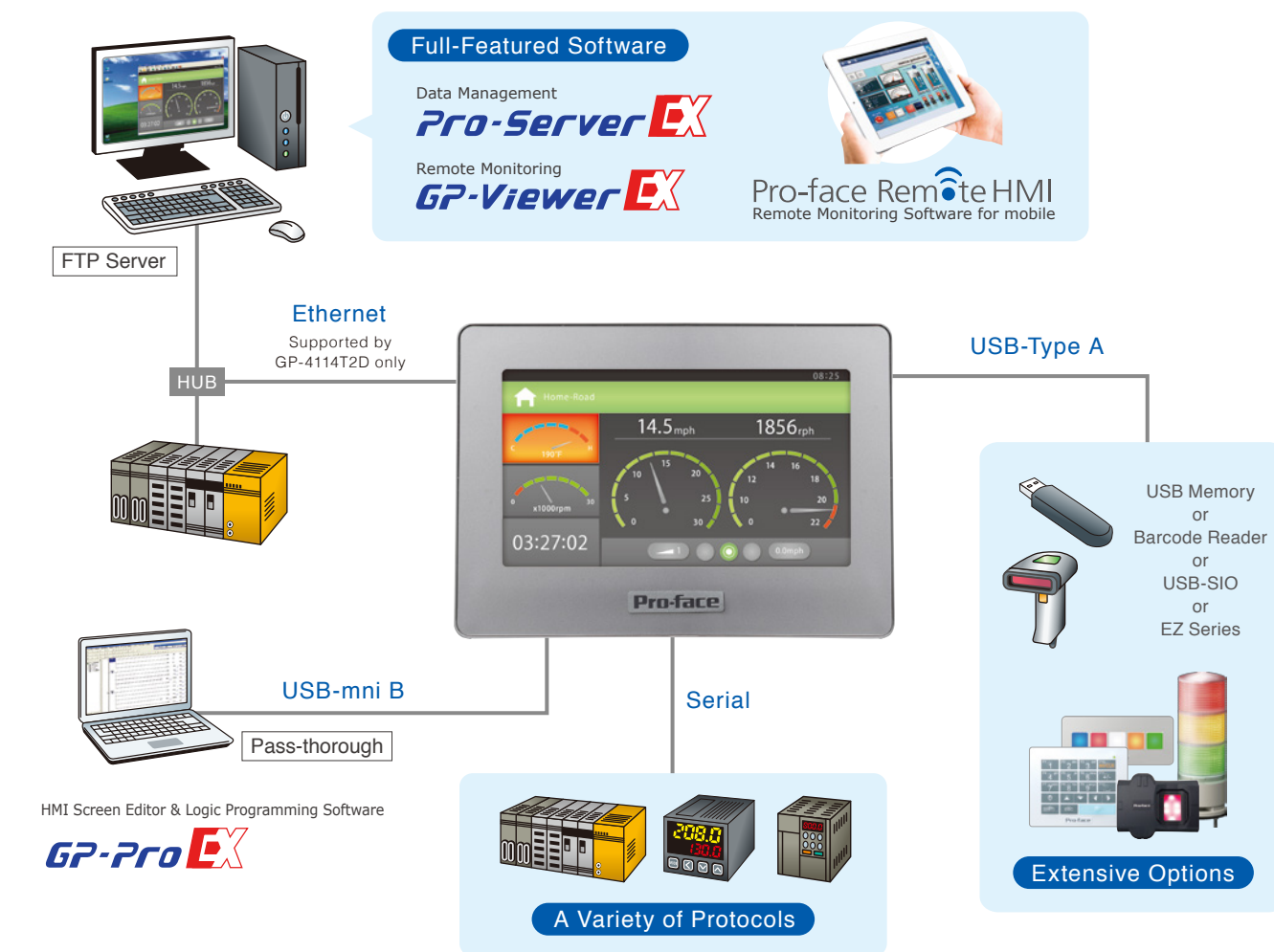

Product Name	Model	Display Size	Resolution	Interface	
GP-4114T2D	PFXGP4114T2D	4.3" Wide	480×272 pixels	Ethernet × 1	USB 2.0 (Type A) × 1,
GP-4115T2D	PFXGP4115T2D			Serial RS232C × 1	
GP-4116T2D	PFXGP4116T2D			Serial RS422/485 × 1	USB 2.0 (mini-B) × 1

## ⚠ WARNING

### HAZARD OF OPERATOR INJURY, OR UNINTENDED EQUIPMENT DAMAGE

Before operating any of these products, be sure to read all related manuals thoroughly.

Failure to follow these instructions can result in death, serious injury or equipment damage.

- For printing purposes, the colors in this catalog may differ from those of the actual unit.
- All product names used in this catalog are the registered trademarks or trademarks of their respective companies.
- Actual user screens may differ from the screens shown here.
- All information contained in this catalog is subject to change without notice.
- Electric equipment should be installed, operated, serviced, and maintained only by qualified personnel. No responsibility is assumed by Digital for any consequences arising out of the use of this material.



### SCIGATE AUTOMATION (S) PTE LTD

No. 1 Bukit Batok Street 22 #01-01 Singapore 659592

Tel: (65) 6561 0488

Fax: (65) 6562 0588

Email: sales@scigate.com.sg

Web: www.scigate.com.sg

Business Hours: Monday - Friday 8.30am - 6.15pm

**Pro-face**

by Schneider Electric

Visit our website for more information.

[www.proface.com](http://www.proface.com)

#### Global Headquarters

Digital Electronics Corporation

[JAPAN] Tel: +81-(0)6-6208-3133

[AUSTRALIA] Tel: +61 (0)3 9550 7396

[DENMARK] Tel: +45 70 22 01 22

[GERMANY] Tel: +49 (0)212 258 260

[ITALY] Tel: +39 0362 59 96 1

[SOUTH KOREA] Tel: +82-(0)2-2630-9850

[SWITZERLAND] Tel: +41 (0)43 343 7272

[SINGAPORE] Tel: +65-6832-5533

#### North/South American Headquarters

Pro-face America, Inc.

[U.S.A.] Tel: +1-734-477-0600

[AUSTRIA] Tel: +43 7236 3343 620

[ENGLAND] Tel: +44 (0)2476 511288

[INDIA] Tel: +91 80 4333 3540

[POLAND] Tel: +48 22 465 66 62

[SPAIN] Tel: +34 (0)93 846 07 45

[TAIWAN] Tel: +886-(0)2-2657-1121

#### European Headquarters

Pro-face Europe B.V.

[THE NETHERLANDS] Tel: +31 (0)23 55 44 099

[CHINA] Tel: +86-(0)21-6361-5175

[FRANCE] Tel: +33 (0)1 60 21 22 91

[INDONESIA] Tel: +62 21 750 4496

[RUSSIA] Tel: +7 (812)336 47 06

[SWEDEN] Tel: +46 46 540 90 70

[THAILAND] Tel: +66-(0)2-617-5678