

## SPG SERIES



Tank gauges SPG series are available with stainless steel wetted parts for all liquid applications compatible with AISI 316 stainless steel.

Special materials as Titanium or HC276 can be considered.

Mounting of the sensor, internally or externally of the tank, meet practically all existing installation requirements.

The SPG Self Powered Gauges have been designed for Marine and Industrial applications. They are completely autonomous and provide remote continuous indication of tank contents without using any external energy.

Indicators are of stainless-steel construction. Calibration in unit of volume and/or depth of liquid.

Each scale is individually calibrated and printed on dial.

### APPLICATION FIELDS & FEATURES

- Marine Certification (RINA)
- ATEX certification
- Standard EN-837-3
- Sea water, Oil and Chemical Resistant
- Submersible or externally mounted sensor



**SCIGATE AUTOMATION (S) PTE LTD**  
No.1 Bukit Batok Street 22 #01-01 Singapore 659592  
Tel: (65) 6561 0488 Fax: (65) 6562 0588  
Email: sales@scigate.com.sg Web: www.scigate.com.sg  
Business Hours: Monday - Friday 8.30am - 6.15pm

## TECHNICAL FEATURES

### General Features

Indicator Nominal Diameter:	DN 100 DN 150
Capillary Length:	Up to 30 m
Calibration:	According to customer specified head or volume units and tank reference (Standard m <sup>3</sup> )

### Measurement Performance

Accuracy:	Class 1 (*)
Error introduced by diaphragm seal and capillary:	<±1,5% FS @ +25°C
System accuracy (0 ÷ 60°C):	<±2% FS (**)
Overload:	150 % FS

### Notes

- (\*) Typical at standard conditions between 10% and 90% FS @ 25°C
- (\*\*) Accuracy related to a 30 meters capillary instrument

## ENVIRONMENTAL FEATURES

### Environmental Conditions

Working temperature limits:	Process: -20 ÷ 130°C Ambient: 0 ÷ 60°C
Ingress protection degree:	Sensor: IP68 @ 30 mH <sub>2</sub> O Indicator: IP65

## APPROVALS

### Type Approvals

Directive 2014/34/EU (ATEX)



Marine type approval

In compliance with applicable requirements of RINA type approval system

## DRY BREAK VALVE ¾" BSP

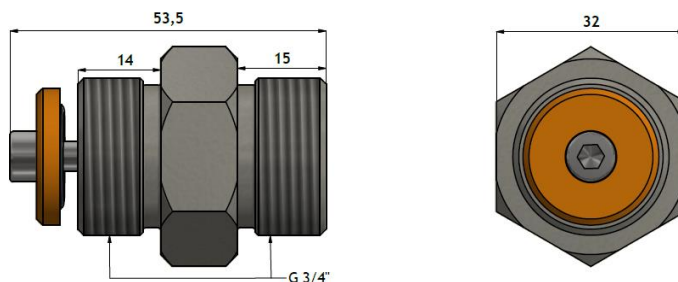

## DIMENSIONAL DRAWINGS

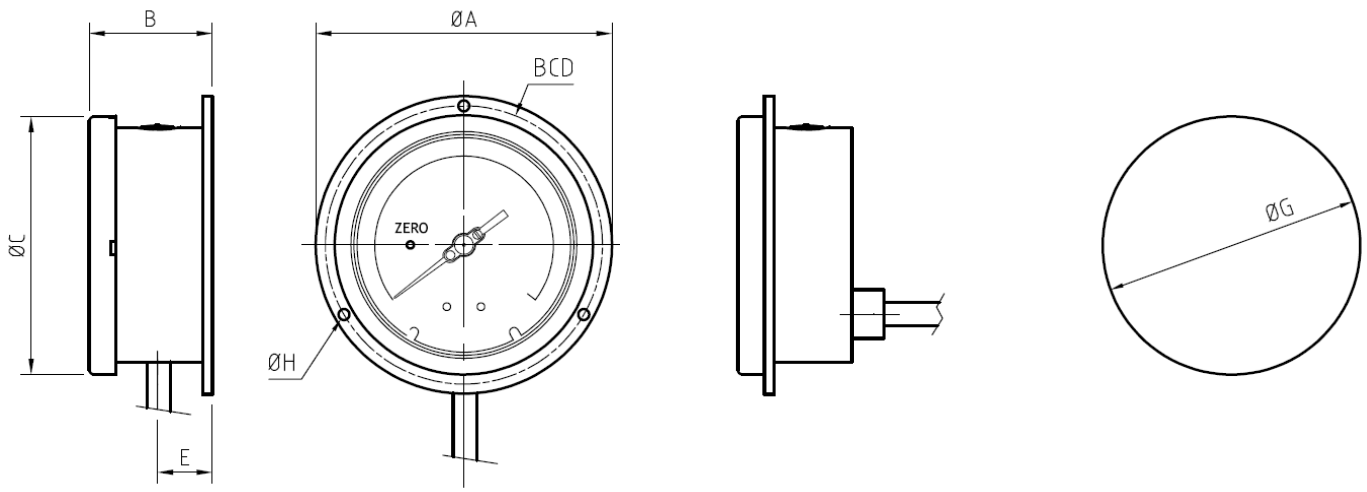

Wall Mounting

Flush Mounting

Panel Cut Out

DN	ØA	B	ØC	E	ØG	ØH	BCD
100	127	55	113	16	100	6	116
150	190	59	163	16	150	6	175

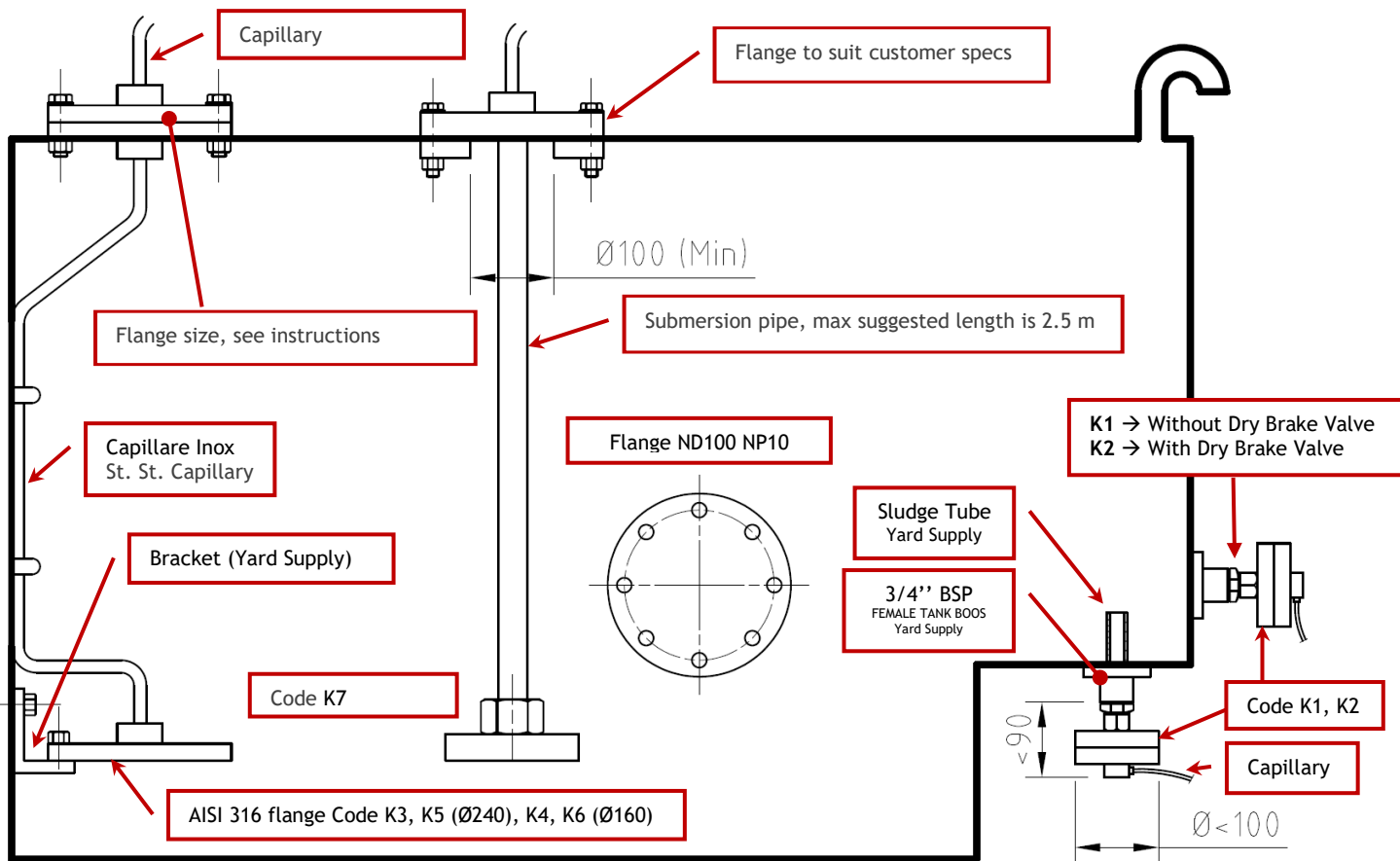

Typical sensor installation

## ORDERING CODE

**SPG** Self powered gauge

### 01 Indicator

- 301 Ø150 mm SS wall mounting (Back Flange)
- 302 Ø150 mm SS panel mounting (Front Flange)
- 303 Ø100 mm SS wall mounting (Back Flange)
- 304 Ø100 mm SS panel mounting (Front Flange)
- Z99 Special

### 02 Process connections

- K1 SS type 316 connection and all wetted parts , ¾" BSP female running nut without Dry Break Valve
- K2 SS type 316 connection and all wetted parts , ¾" BSP female running nut with Dry Break Valve
- K3 St.st.316 submersible Ø240 mm flanged sensor and bulkhead AISI 304 rectangular flange
- K4 St.st.316 submersible Ø160 mm flanged sensor and bulkhead AISI 304 rectangular flange
- K5 St.st.316 submersible Ø240 mm flanged sensor and bulkhead rectangular flange and protection guard in SS AISI 304
- K6 St.st.316 submersible Ø160 mm flanged sensor and bulkhead rectangular flange and protection guard in SS AISI 304
- K7 SS AISI 316 submersible sensor with pipe L<sub>MAX</sub>=2.5 m and flange
- Z9 Special

### 03a Capillary length

- |     |  |               |
|-----|--|---------------|
| 11_ | Copper capillary + SS AISI 304 sheath      | 1 ... 1.9 m   |
| 12_ | Copper capillary + SS AISI 304 sheath      | 2 ... 4.9 m   |
| 13_ | Copper capillary + SS AISI 304 sheath      | 5 ... 9.9 m   |
| 14_ | Copper capillary + SS AISI 304 sheath      | 10 ... 20 m   |
| 21_ | SS AISI 304 capillary + SS AISI 304 sheath | 1 ... 1.9 m   |
| 22_ | SS AISI 304 capillary + SS AISI 304 sheath | 2 ... 4.9 m   |
| 23_ | SS AISI 304 capillary + SS AISI 304 sheath | 5 ... 9.9 m   |
| 24_ | SS AISI 304 capillary + SS AISI 304 sheath | 10 ... 19.9 m |
| 25_ | SS AISI 304 capillary + SS AISI 304 sheath | 20 ... 30 m   |
| Z9_ | On request                                 |               |

### 03b Measuring range

- \_A Nominal measuring range (mH2O) 0÷1
- \_B Nominal measuring range (mH2O) 0÷1,6
- \_C Nominal measuring range (mH2O) 0÷2,5
- \_D Nominal measuring range (mH2O) 0÷4
- \_E Nominal measuring range (mH2O) 0÷6
- \_F Nominal measuring range (mH2O) 0÷10
- \_9 On Request

### 04 Options and accessories

- 01 Test certificate according to EN 10204
- 02 AG transcription
- 03 Calibration report
- 04 RINA type approval
- 05 Other type approval
- 06 ATEX certificate  II 2 GDC TX
- 07 Size ¾" isolation valve (TIV) for codes K1 & K2.
- 08 Single scale (Volume → m<sup>3</sup> or liters)
- 09 Double scale (Volume + H → m<sup>3</sup> or liters + m)
- 10 Dry display
- Z9 On Request